

The Hillman Hase Minx Book

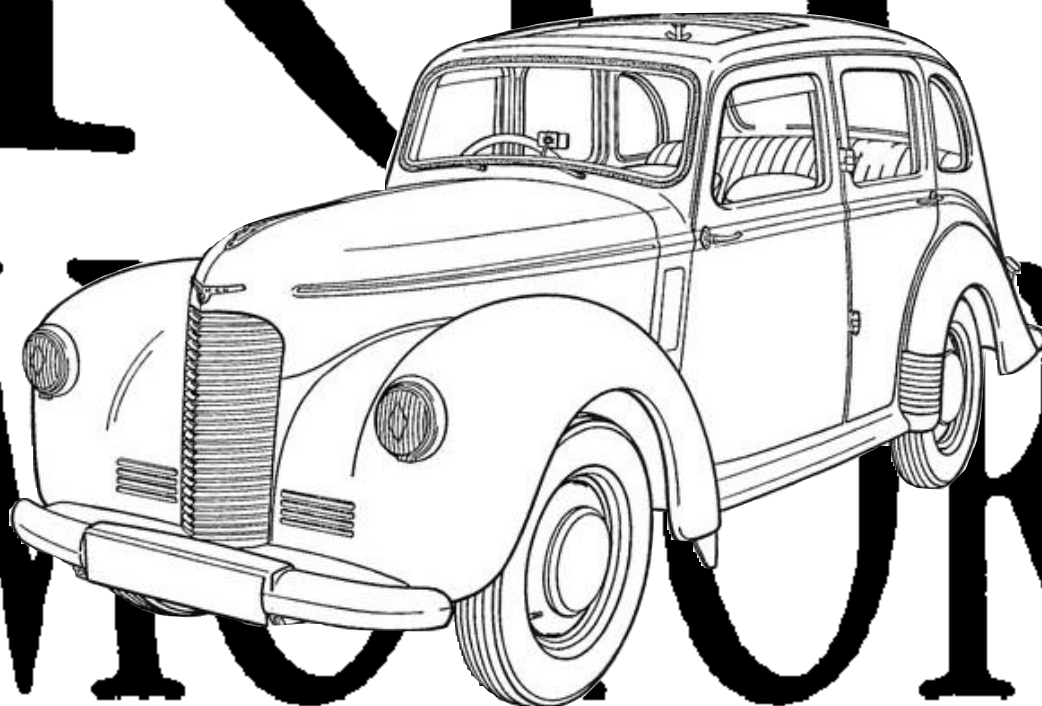

COMPANY

One Call Does It All!
Parts, Service & Restoration
for Uncommon British Vehicles

www.ipmotor.com

(888) 243-0440



Kip Motor Company is a full service antique automobile parts, restoration and repair facility. We perform complete or partial restorations on a wide variety of British automobiles. Our many projects range from show cars to daily drivers.

Using this Catalog

Parts listed in this catalog are currently available, normally stocked items or those planned for production. Unless otherwise indicated, all items are New or New Old Stock. (X) - indicates rebuilt items sold *exchange only*. Your rebuildable part must be received in exchange before one is shipped. A number following in the parenthesis indicates items where cores are generally available. The number represents a core charge that will be added to your invoice, *where cores are available*. The core charge is refunded upon receipt of your rebuildable core. (U) - indicates used parts. *Price and availability is subject to change without notice*.

Ordering by Phone

Our telephone order lines are open:

Monday through Friday	9:00a.m. - 6:00p.m. CST
Saturday	9:00a.m. - 12 noon CST

Ordering Online or by Mail, E-mail or Fax

Kip Motor has a secure, online shopping cart for this catalog at www.kipmotor.com. Prices are current online! If ordering by e-mail or fax, please include: your name, address, telephone number, make, model and year of car, engine & chassis numbers, ship to address and credit card information. If enclosing a check or money order, be sure to enclose sufficient funds to cover shipping charges. Any overage will be refunded. Orders paid by check will be held for two weeks prior to shipping. E-mail address: info@kipmotor.com

Payments

We accept Visa, Mastercard, American Express & Discover. Please have available your credit card number, expiration date, name and address of card holder and telephone number. COD orders are usually accepted, an additional \$9 fee will be incurred. Air, truck freight and international shipments must be pre-paid.

Warranty

All parts are warranted against defects in material and workmanship for a period of one year from date of shipment. If a part fails in service, it will be exchanged for a similar part whenever available. This warranty covers only the part and does not include labor or failure of a related component. In no case would the liability of KMC exceed the cost of the original part.

Shipping

Orders are shipped ground freight unless otherwise specified. Expedited and air delivery is available at extra cost. Oversize and heavy items are shipped via truck, freight collect. International and overseas orders may be shipped by post, UPS or other means as required.

International customers should indicate their preference at time of order. If your shipment arrives damaged, notify the carrier immediately, before contacting KMC for further instructions.

For orders within the 48 contiguous United States, shipping and handling charges will be added to invoices at the following rates:

Order Total	Shipping Charge
\$.00 - 20.00	\$9.00
20.01 - 50.00	12.00
50.01 - 75.00	15.00
75.01 - 100.00	20.00
100.01 - 150.00	25.00
150.01 - 250.00	29.00
250.01 - 350.00	33.00
350.01 - 500.00	36.00
500.01 - 1000.00	39.00
1000.01 +	FREE GROUND SHIPPING

Shipping charges to other areas will vary accordingly.

Returns

Returns are accepted for full refund or exchange up to 90 days from date of purchase (shipment). Returns are accepted for exchange only, up to 180 days from date of purchase (shipment). Special orders and returns exceeding the listed limits may or may not be accepted, with or without a restocking fee, at the discretion of KMC. Returns must be accompanied by a copy of the original invoice. Include a note indicating the reason for return. All items must be in the same condition as shipped. *Items cut, fitted, painted, etc., will not be accepted.*

Backorders

We normally stock all items in our catalog. From time to time some items may be temporarily out of stock or no longer available. These items will be indicated as backordered on your invoice. In most cases, backordered items will ship within 1-2 weeks. Occasionally certain items take longer. Any backordered item not shipped within 60 days of the original order will be automatically dropped unless specifically requested otherwise.

Other Catalogs Available

KMC has parts and catalogs for many British cars and commercial vehicles. Other catalogs available at the time of printing include:

The London Taxi Book	(Austin FX3/FX4/FL1/FL2 & Beardmore)
The Orphan Book	(vehicles not covered in specific catalog)
The English Ford 100E Book	(Angelia and other 100E makes)
The Berkeley Book	
The Metropolitan Book	(Hudson, Nash, and AMC Metropolitans)

© Copyright 2013 - Kip Motor Company, Inc.

All rights reserved. No part of this publication may be copied, reproduced, stored in any retrieval system, communicated or transmitted in any form or means without the express written permission of Kip Motor Company, Inc.

Table Of Contents

Body Fittings Saloon	19-21
Body Fittings Coupe	22-24
Body Fittings Utility	25-27
Brakes	9-11
Bumpers	17-18
Carburettor	6
Clutch	7
Cooling	9
Crankshaft	4
Dashboard	12
Driveshaft (Propeller Shaft)	9
Electrical	12-14
Engine	3-5
Exhaust System	16
Front Axle	8
Fuel (Petrol) Pump	5
Gearbox	7
Grille	17
Ignition	13
Jack/Tools	16
Lamp/Lenses	12
Master Cylinder	10
Manuals	28
Oil Assembly	5
Petrol System	15
Propellor Shaft	9
Radiator	15
Rear axle	8
Starter	12
Steering	11
Suspension	14
Switches	13
Tools	16
Trafficator	13
Trim	17-18
Upholstery	20-27
Wheels	18
Window Regulators	20-27
Windshield Wipers/Wiper Motor	14

Hillman Phase Minx

About This Catalog:

The Hillman Phase Minx parts catalog is based on the "Hillman Minx Service Parts Catalog for 1948 Models" published in October, 1947 by ROOTES LIMITED. This catalog follows the original publication's category order and also uses the line illustrations to assist you with identifying the correct part you need.

For vehicles starting with CHASSIS Number 1865001.

General Instructions for Ordering Parts:

To receive the correct parts for your Phase Minx, please provide the following information:

CAR TYPE

1. Model
2. Chassis Number
3. Engine Number
4. Body Style (Saloon, Coupe, or Utility)

PARTS REQUIRED

1. Part Number and Description
2. Quantity
3. Right or Left (if applicable)
4. Right Hand Drive(RHD) or Left Hand Drive (LHD)
5. Colour (if applicable)

HILLMAN MOTOR CAR CO LTD		
COVENTRY, ENGLAND.		
WHEN ORDERING PARTS QUOTE		
CHASSIS NO	<input type="text" value="X"/>	<input type="text"/>
ENGINE NO	<input type="text"/>	
BODY NO	<input type="text"/>	
RECOMMENDED LUBRICANTS		
NORMAL CLIMATIC CONDITIONS		

The **CHASSIS Serial Number** is stamped in the space marked "X" above, on a plate secured to the right-hand side of the firewall just under the bonnet. The **ENGINE Number** will also be found on this plate. Please provide these numbers to avoid inaccurate interpretation of orders.

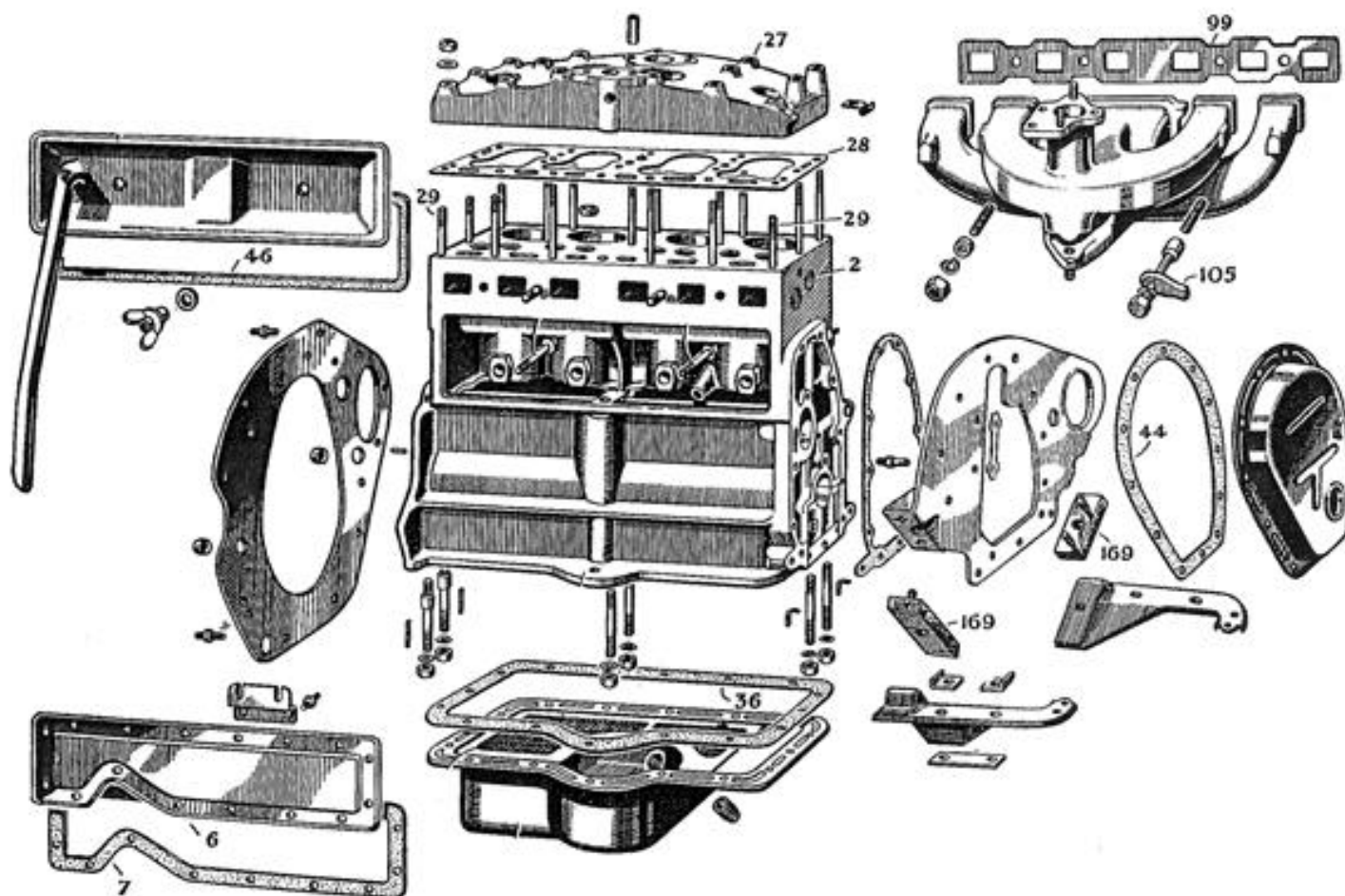

Engine External

No	Part #	Description	Application	Qty Req	Cost Each
	P.48038	Engine assembly (X)		1	3785.00
	CB510	Head gasket set		1	90.75
	EB510	Conversion gasket set		1	142.78
2	D.7	Sealing disc (35 m/m dia)		4	2.12
2	D.11	Sealing disc (48 m/m dia)		1	3.94
6	P.22322	Side water plate, stainless steel		1	135.00
7	P.22323	Side cover joint		1	11.75
	SCR.96	Screw 1/4", side water plate		14	NCA
27	P.78404	Cylinder head		1	NCA
28	P.78405	Gasket cylinder head		1	33.29
29	P.55961	Stud 2 9/16" long, cylinder head		4	22.30
	P.55962	Stud 3" long, cylinder head		5	23.60

No	Part #	Description	Application	Qty Req	Cost Each
36	P.22327	Sump joint (gasket)		1	15.25
44	P.22149	Timing cover joint (gasket)		1	15.12
46	P.22325	Valve cover joint (gasket)		1	34.00
66	P.22208	Lock tab, set of 8		1	7.25
89	P.82048	Top water pipe		1	NCA
92	P.82049	Inlet water branch		1	NCA
99	P.38343	Inlet and exhaust joint (gasket)		1	10.29
105	P.80047	Oil pump assembly (X)		4	195.00
169	P.65698	Engine mount, rubber		2	66.55

(X) indicates rebuilt items sold exchange only i.e. send in your part to be rebuilt.
NCA - not currently available, please inquire.
If you don't see the part you need listed, please ask!

Engine rebuilding is one of our specialties!

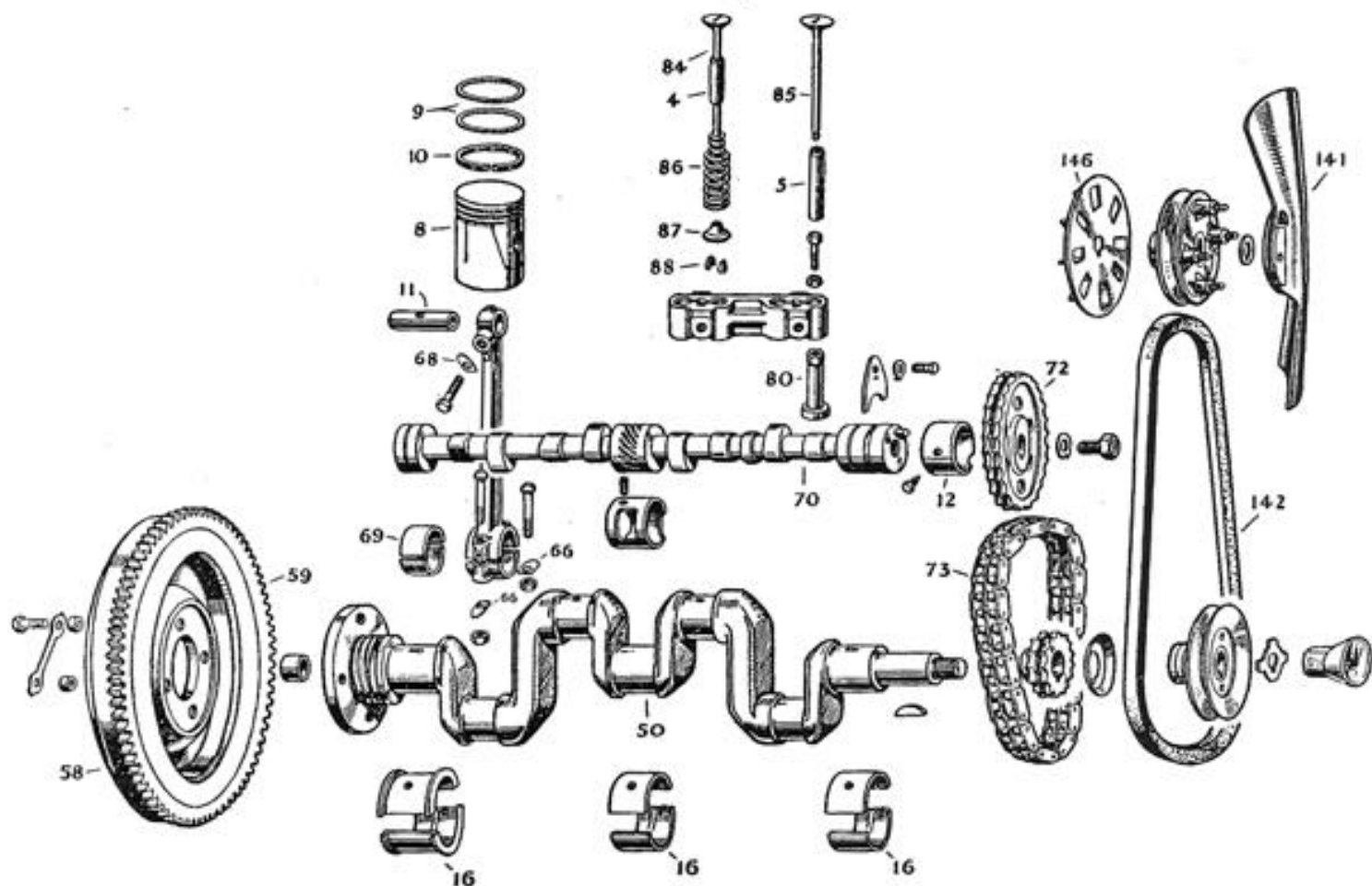

Engine Internal (Above)

No	Part #	Description	Application	Qty Req	Price Each
4	P.22186	Inlet value guide - std.		4	NCA
5	P.78669	Exhaust value guide		4	NCA
8-10	P.48015	Piston set w/rings .020		1	415.00
	P.80750	Piston ring set, std		1	119.85
12	P.47634	Camshaft front bush		1	39.00
16	P.54327	Main bearing set		1	225.00
50	P.80747	Crankshaft (x)		1	199.65
58	P.47171	Flywheel and starter ring		1	NCA
59	P.81085	Starter ring		1	224.00
68	P.22208	Lock tab set of 8		1	7.25
69	P.53856	Connecting rod bearing standard size		8	165.00
69	P.53856-10	Connecting rod bearing (.010 undersized)		8	165.00
69	P.53856-20	Connecting rod bearing (.020 undersized)		8	165.00
69	P.53856-30	Connecting rod bearing (.030 undersized)		8	165.00
69	P.53856-40	Connecting rod bearing (.040 undersized)		8	165.00
70	P.48026	Camshaft, reground (X)		1	115.00
73	P.22296	Timing chain		1	29.04
80	P.25409	Tappet c/w nut and screw (X)		8	24.00
84	P.38950	Valve, inlet		4	16.94

No	Part #	Description	Application	Qty Req	Price Each
85	P.77813	Valve, exhaust		4	19.36
86	P.47885	Spring (inner and outer) set		4	79.00
87	P.38804	Cup, valve		8	6.25
88	P.38948	Valve cotter set		8	18.00
141	P.66881	Fan assembly (U)		1	45.00
142	P.65932	Fan belt		1	30.86
146	P.53477	Ventilator - dynamo		1	NCA

(X) indicates rebuilt items sold exchange only. Please ship your part to be rebuilt. A number inside the () represents a core charge that is refunded once we receive your *rebuildable* core. Core charges are not applicable towards the Free Ground Shipping total.

NCA - Not currently available, please inquire.

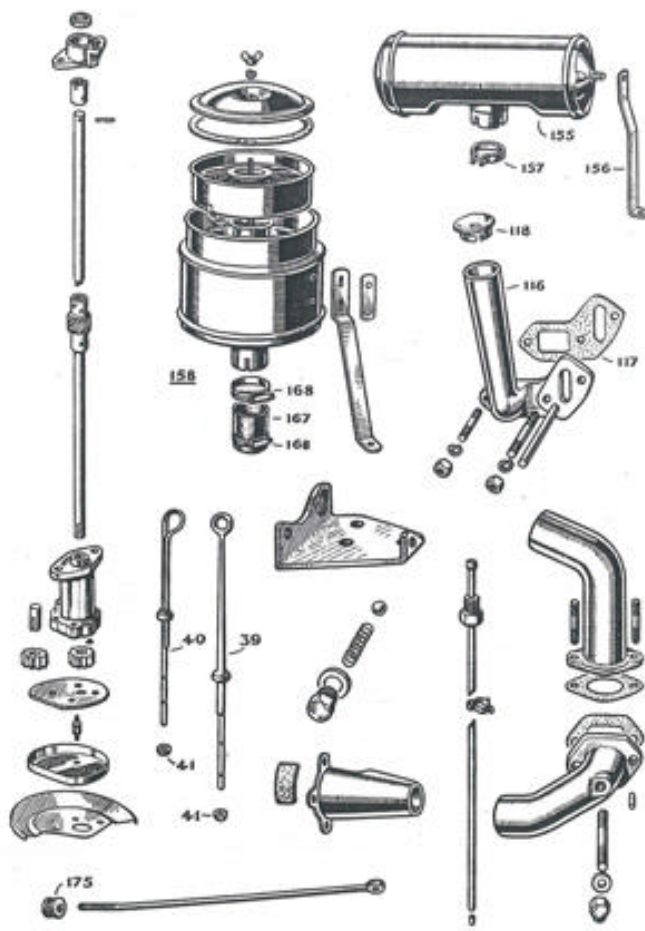

Engine Accessories - Oil Filler/Silencer (left)

No	Part #	Description	Application	Qty Req	Cost Each
39	P.78731	Dipstick assembly RHD		1	NCA
40	P.78730	Dipstick assembly LHD		1	NCA
41	P.78729	Felt washer - dipstick collar		1	NCA
116	P.78410	Oil Filler		1	11.80
117	P.22786	Gasket, oil filler		1	6.50
118	P.55347	Oil cap		1	78.65
155	P.78678	Air silencer		1	NCA
156	P.78959	Air silencer, bracket		1	42.00
167	P.76724	Connecting hose		1	7.50
168	P.68589	Clip, hose		2	3.75
175	P.56418	Engine tie rod buffer		1	5.27

*Note: RHD - Right Hand Drive; LHD- Left Hand Drive
NCA- Not currently available; please inquire.

Petrol Pump (Right)

No	Part #	Description	Application	Qty Req	Price Each
1	P.44322	Petrol (fuel) pump (X 20)		1	114.95
	7H903	Repair kit, petrol pump		1	36.00

(X) indicates rebuilt items sold exchange only. Please ship your part to be rebuilt. A number inside the () represents a core charge that is refunded once we receive your rebuildable core. Core charges are not applicable towards Free Ground Shipping rate.

For fuel lines and gas tank assemblies, see Petrol System, page 15.

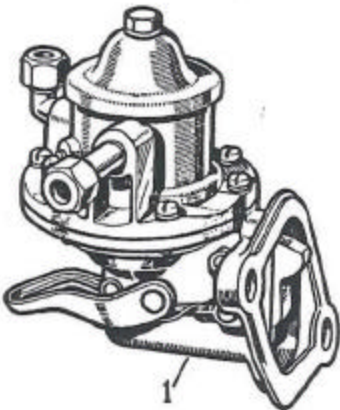

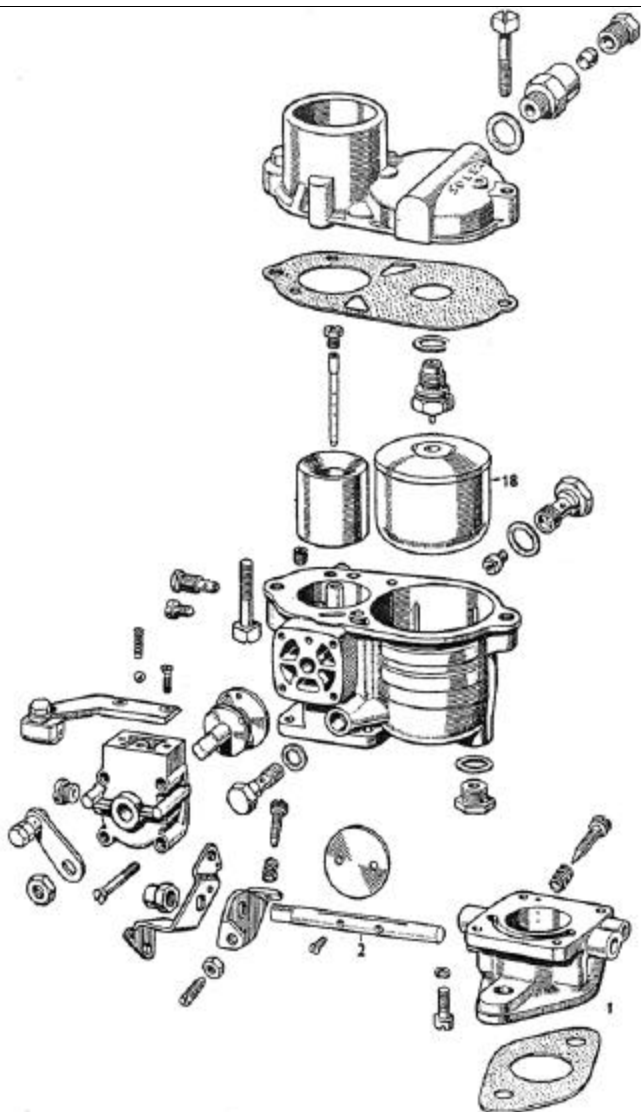

Carburettor (Left)

No	Part #	Description	Application	Qty Req	Price Each
	P.78185	Carburettor (X120)		1	420.00
1	GP74	Gasket pack, carburettor		1	25.72
2	K.11401	Throttle spindle		1	165.00
18	K.12551	Float, carburettor-30FAI		1	21.00

(X) indicates rebuilt items sold exchange only. Please ship your part to be rebuilt. A number inside the () represents a core charge that is refunded once we receive your rebuildable core. Core charges are not applicable towards Free Ground Shipping total.

Carburettor Controls (Below)

No	Part #	Description	Application	Qty Req	Price Each
80, 81	P.44084	Choke control type S/10C/46 assembly		1	95.75

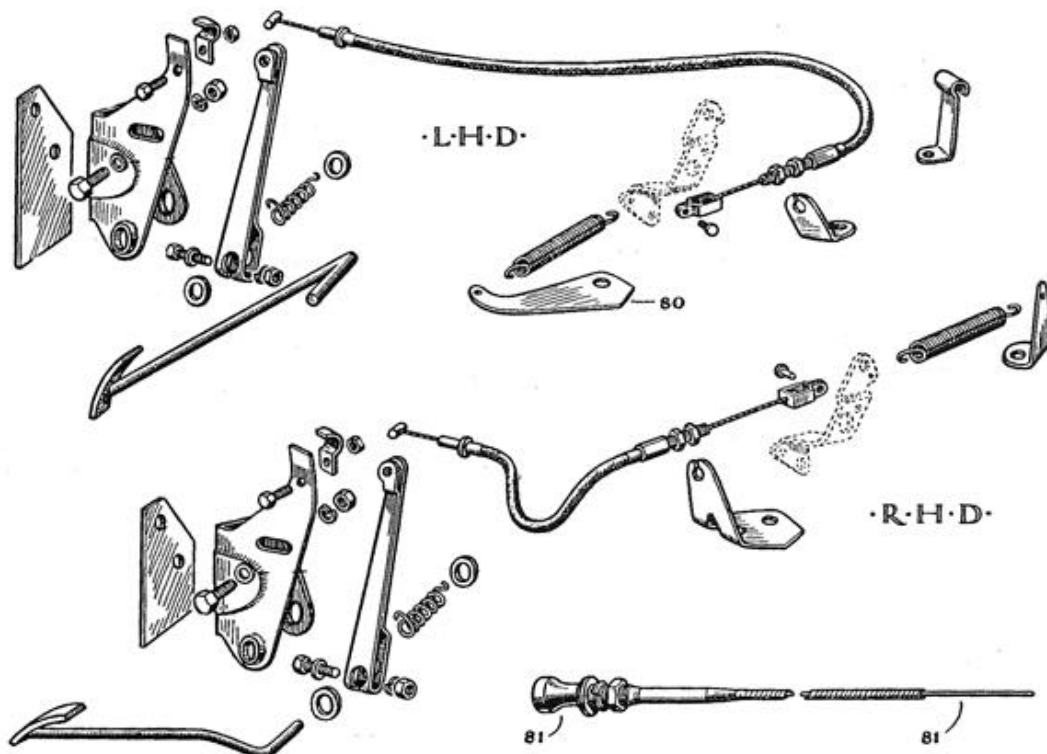

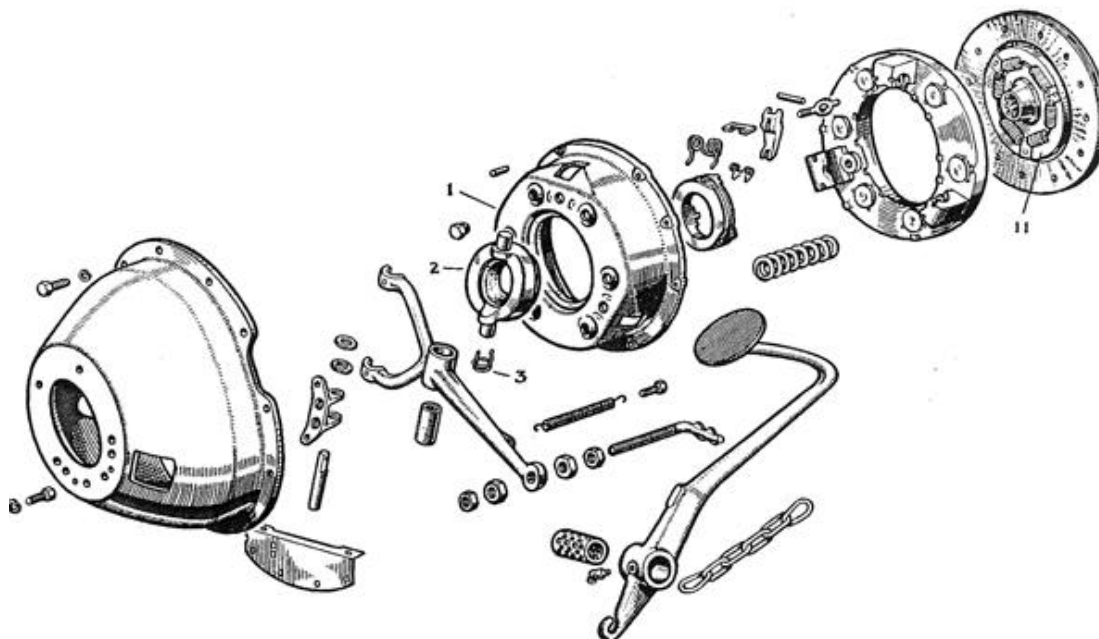

Clutch (Above)

No	Part #	Description	Application	Qty Req	Price Each
1	K.5597	Clutch cover assembly (X)		1	139.15
2	K.10038	Release bearing and cup assembly		1	84.00
3	K.11795	Release bearing retainer		2	2.85
11	K.12833	Drive plate assembly (X75)		1	95.00
	ME-3833-E	Brake fluid, Castrol GT LMA 12 oz		2	8.17

(X) indicates rebuilt items sold exchange only. Please ship your part to be rebuilt. A number inside the () represents a core charge that is refunded once we receive your *rebuildable* core. Core charges are not applicable to the Free Ground Shipping total.

Gearbox (Below)

No	Part #	Description	Application	Qty Req	Price Each
	P.48027	Gearbox unit (X)		1	1,425.00
		Gearbox gasket set		1	NCA
10	P.79445	Bush, primary shaft		2	NCA
11	P.42735	Bearing, primary shaft		1	57.48
17	P.55515	Bearing, mainshaft		1	45.38
38	P.40234	Rollers		54	3.75
	P.81588	Knob, gear shift lever		1	65.00
	P.78176	Rubber, top		1	NCA
	P.78177	Rubber, bottom		1	NCA

(X) indicates rebuilt items sold exchange only. Please ship your part to be rebuilt. A number inside the () represents a core charge that is refunded once we receive your *rebuildable* core. Core charges are not applicable towards the Free Ground Shipping total.

NCA- not currently available; please inquire.

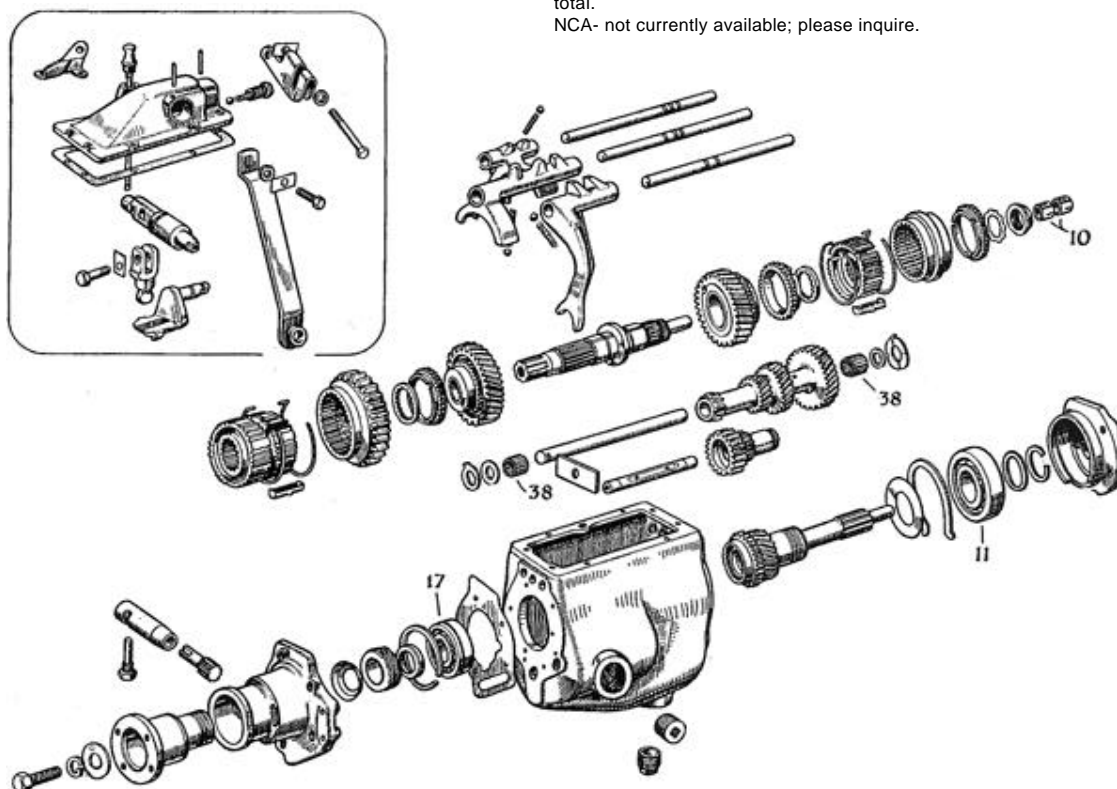

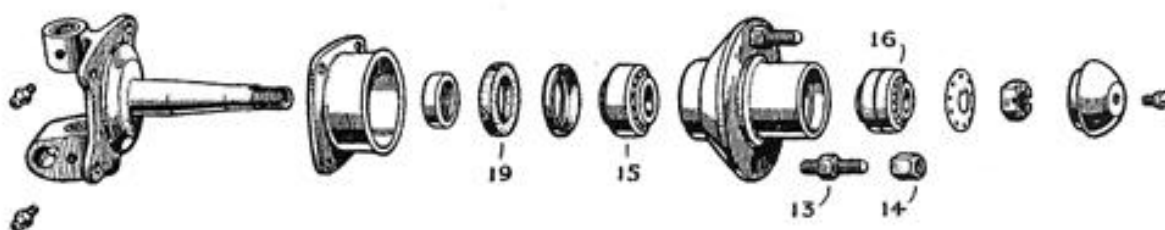
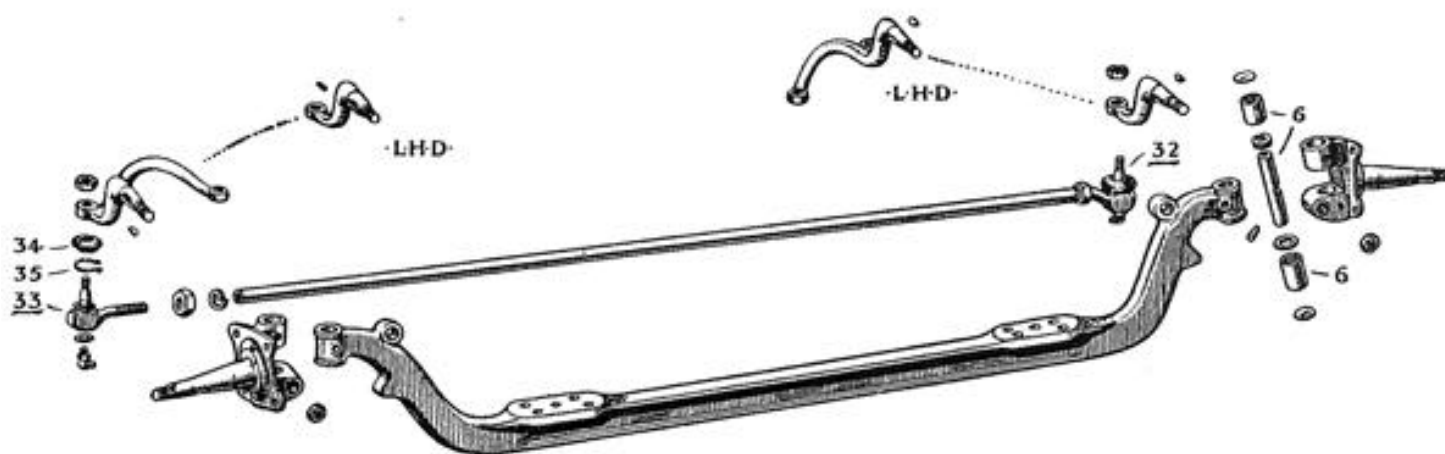

Front Axle (Above)

No	Part #	Description	Application	Qty Req	Price Each
6	P.47916	Swivel pin and bushes kit		2	245.00
13	P.82660	Driving stud		6	28.14
14	P.22369	Driving stud nut		6	23.90
15	P.40235	Hub inner bearing		2	56.27
16	P.40236	Hub outer bearing		2	42.05
19	P.22117	Packing washer, inner bearing		2	17.85
32	K.18971	Track rod socket assembly RH thread		1	NCA
33	K.18972	Track rod socket assembly LH thread		1	NCA
34	K.18968	Boot, socket assembly		2	5.45
35	K.18969	Clip, boot		2	4.42

Rear Axle (Below)

No	Part #	Description	Application	Qty Req	Price Each
15	P.29812	Oil seal, axle	Saloon and Coupe	2	25.41
A5	P.67998	Oil seal, axle casing	Utility	2	20.88
11	P.56549	Bearing, differential		2	138.00
14	P.55588	Wheel, differential		2	73.50
24	P.55595	Bearing, bevel pinion		2	398.00
32	P.82660	Driving shaft stud, road wheel	Saloon and Coupe	6	28.14
32	P.82673	Axle shaft	Utility	2	4495.00
34	P.22369	Driving stud nut		2	23.90
37	P.40077	Bearing (drive shaft assembly)	Saloon and Coupe	2	45.38
37	P.40006	Bearing (drive shaft assembly)	Utility	2	51.43
38	P.29816	Oil retainer assembly		2	25.41
42	SCR.10	Screw, brake drum to axle shaft		6	NCA
64	P.80101	Pipe, RH (rear axle)	Saloon and Coupe	1	NCA
65	P.80102	Pipe, LH (rear axle)	Saloon and Coupe	1	NCA
67	P.44132	3-way connector, rear		1	NCA
	P.79624	Road wheel, front and rear		4	199.65
	P.79625	Hubcab		4	125.00

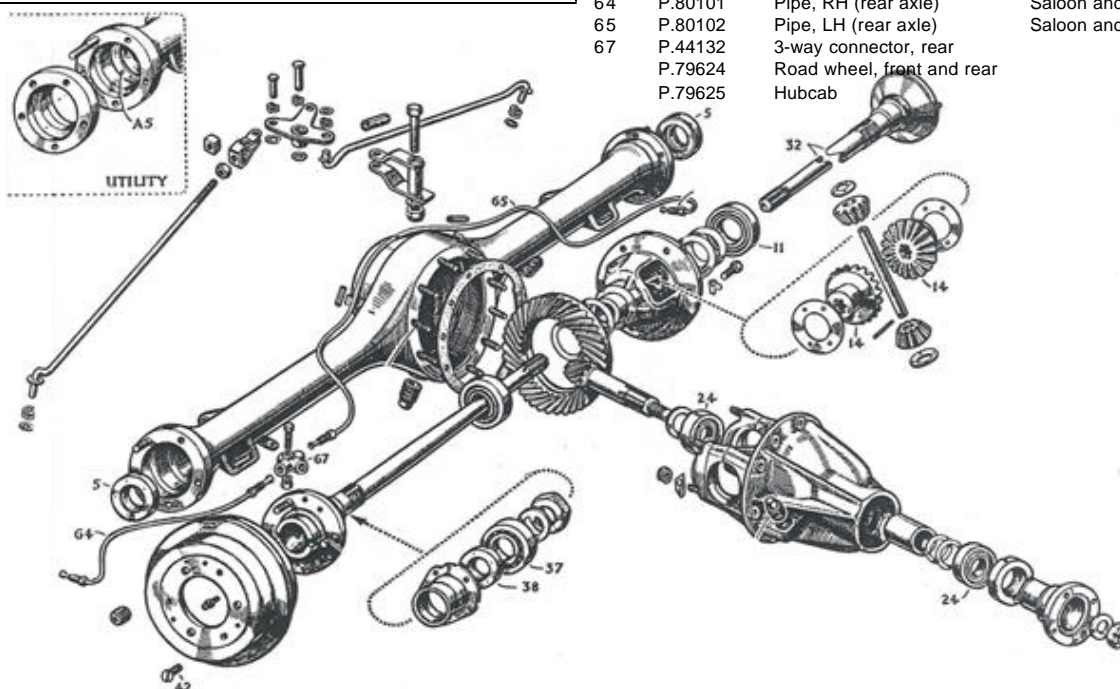

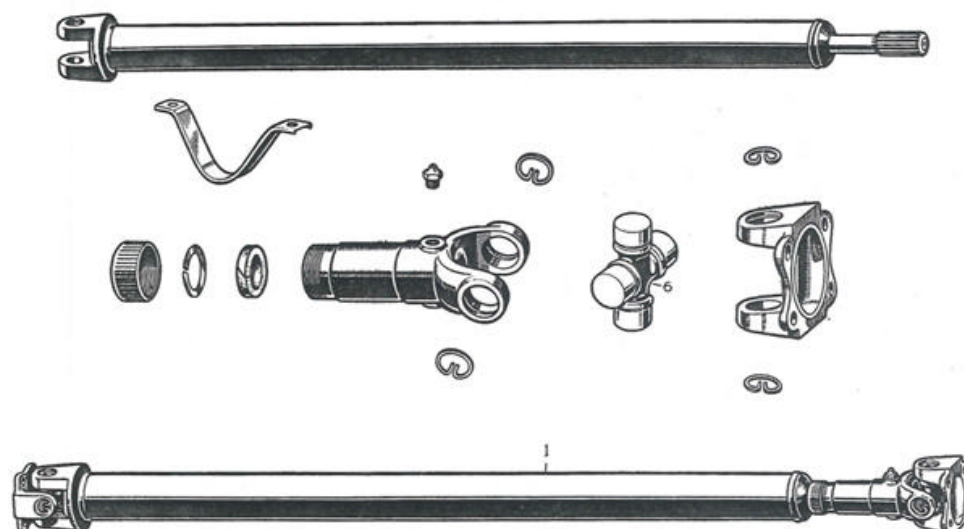

Propellor Shaft (above)

No	Part #	Description	Application	Qty	Cost
1	P.38098	Propellor shaft (drive shaft) (X)		1	199.65
6	K.18244	Journal and bearing pack		2	29.95

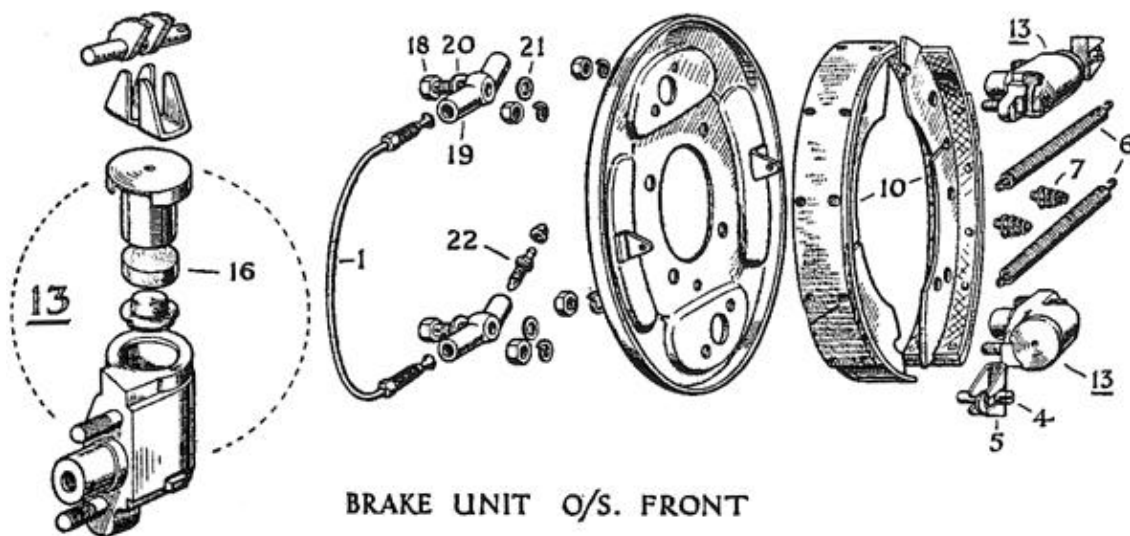

Front Brakes (Above)

No	Part #	Description	Application	Qty Req	Price Each
1	P.79865	Bridge tube		2	NCA
4, 5	K.19030	Adapter, micram and mask		4	99.83
6	K.19032	Pull off spring		4	16.34
7	K.19033	Steady spring		4	5.75
10	K.19034	Front brake shoe set (X75)		1	69.00
13	K.19035	Wheel cylinder, RH		2	225.00
13	K.19036	Wheel cylinder, LH		2	225.00
16	K.19040	Cup, wheel cylinder		4	9.85
18	K.19043	Bolt		2	17.85
19	K.19044	Two way piece		4	NCA
20	K.19045	Gasket		4	17.85
21	K.41466	Gasket, small		4	1.03
22	K.19046	Bleeder screw (bottom wheel cylinder only)		2	5.85
	ME-3833-E	Brake fluid, Castrol GT LMA 12 oz		4	8.17

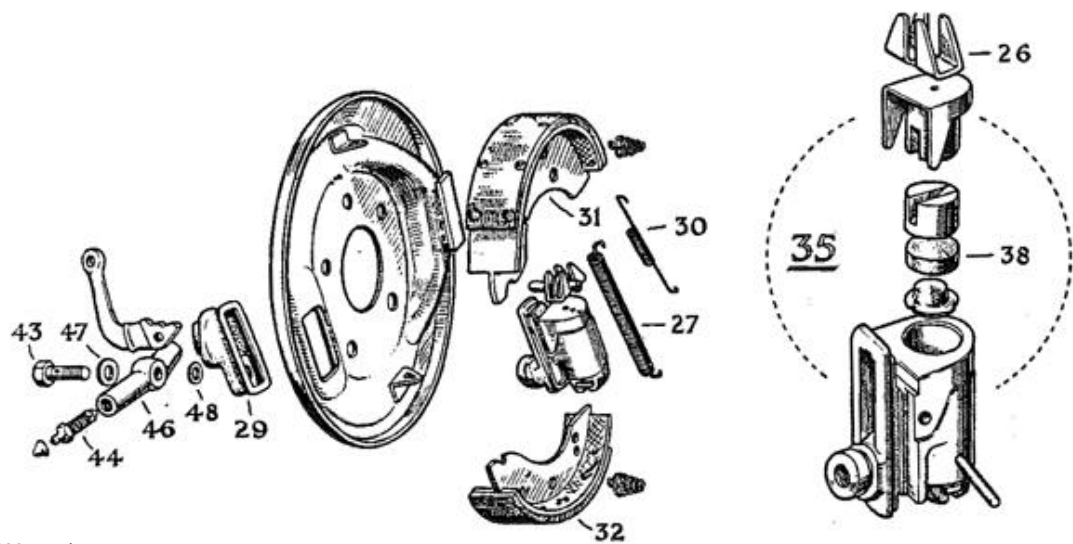

Rear Brakes (Above)

No	Part #	Description	Application	Qty Req	Price Each	No	Part #	Description	Application	Qty Req	Price Each
25, 26	K.19030	Adjuster, micram and mask		2	99.83	43	K.19043	Bolt, wheel cylinder		2	17.85
27	K.19032	Pull off spring		2	16.34	44	K.19046	Bleeder screw		2	5.85
28	K.19033	Steady spring		4	5.75	46	K.19058	Two way piece		2	NCA
29	K.19049	Boot - wheel cylinder to backing plate		2	15.25	47	K.19045	Gasket		2	1.16
30	K.19050	Tension spring		2	8.47	48	K.41466	Gasket, small		2	1.03
31&32	K.19034	Rear brake shoe set (leading and trailing) (X75)		1	144.00		ME-3833-E	Brake fluid, Castrol GT LMA 12 oz		4	8.17
35	K.19051	Wheel cylinder, rear		2	275.00						
38	K.19040	Cup, wheel cylinder		2	9.85			NCA - not currently available; please inquire.			

NCA - not currently available; please inquire.

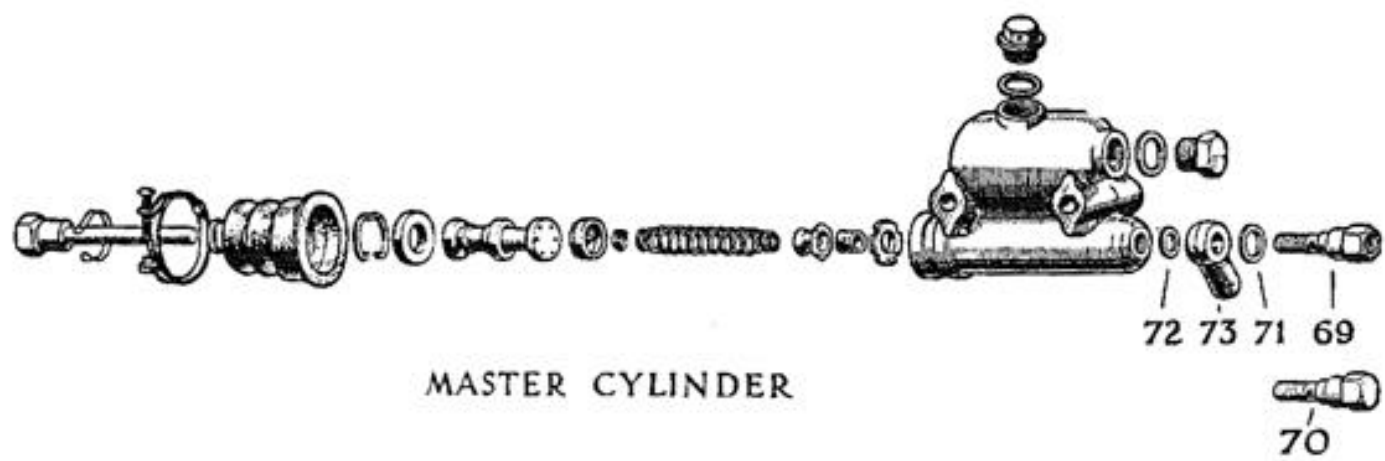

MASTER CYLINDER

Master Cylinder (Above)

No	Part #	Description	Application	Qty Req	Price Each
	K.20043	Master cylinder		1	308.55
	P.80765	Master cylinder repair kit		1	41.45
69	P.44113	Union bolt RHD		1	32.37
71	K.19045	Gasket		1	1.16
72	P.41466	Gasket, small		1	1.03
73	P.44135	Banjo connection, master cylinder		1	35.25
	ME-3833-E	Brake Fluid, Castrol GT LMA 12 oz		4	8.17

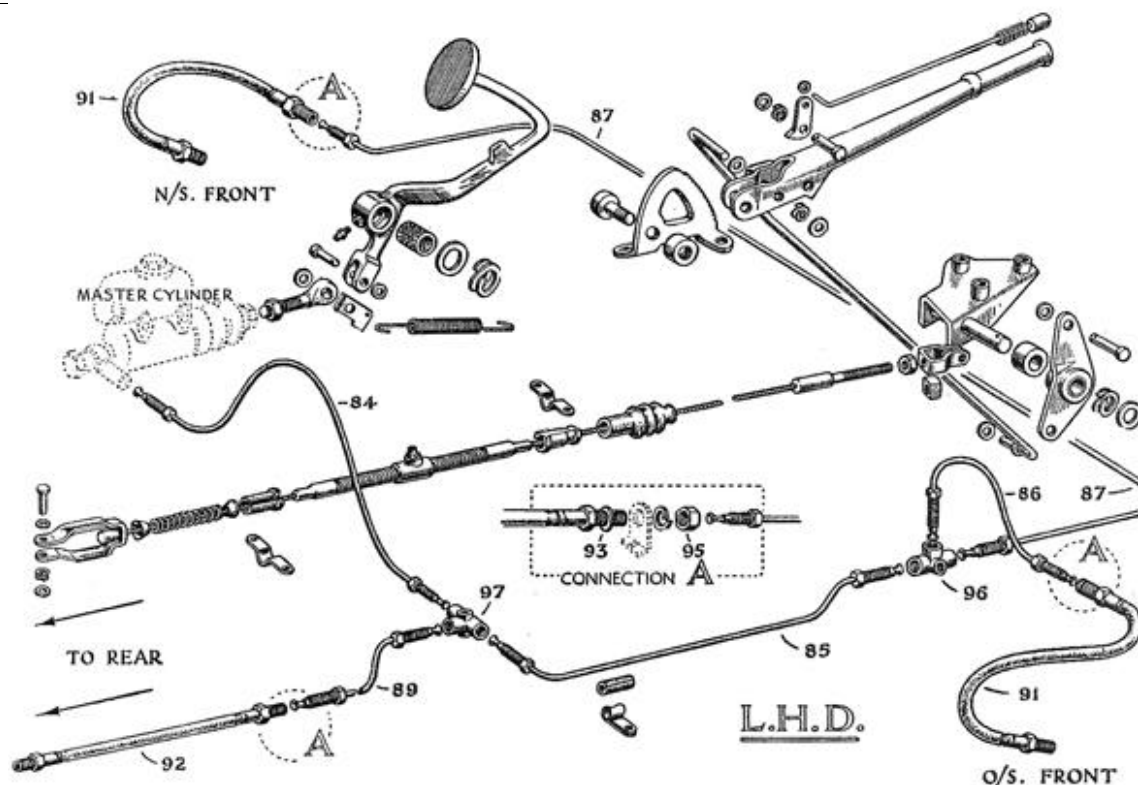

Brake Lines (Above)

No	Part #	Description	Application	Qty Req	Price Each
	P.80097	Pipe, master cylinder to front 3 way RHD		1	NCA
84	P.79866	Pipe, master cylinder to T piece LHD		1	NCA
85	P.80097	Pipe, T piece to front 3 way LHD		1	NCA
86	P.80098	Pipe, front to 3 way, RH		1	NCA
87	P.80099	Pipe, front to 3 way, LH		1	NCA
	P.80100	Pipe, master cylinder to rear hose (RHD)		1	NCA
89	P.80100	Pipe, T piece to rear hose (LHD)		1	NCA
91	P.44137	Hose, front		2	56.43
92	P.44136	Hose, rear		1	51.43
93	P.42773	Gasket, hose to pipe		3	1.16
95	P.42774	Nut, hose to pipe		3	NCA
96	P.44132	Connection, 3 way (RHD)		1	NCA
97	P.44132	Connection, T piece (LHD)		1	NCA

Steering (Below)

No	Part #	Description	Application	Qty Req	Price Each
	P.80970	Steering unit, RHD (x)		1	525.00
	P.80971	Steering unit, LHD (X)		1	525.00
20	K.18292	Steering rocker shaft bush trunion		1	NCA
27	H.76507	Grommet, column clip (LHD)		1	NCA
28	P.53882	Steering box clamp (gland body)		1	NCA
34	P.80945	Steering wheel (X)		1	525.00
	K.19583	Steering column top cover c/w horn push		1	NCA
39	K.18961	Socket assembly R.H. thread for drag link		1	NCA
	K.18962	Socket assembly L.H. thread for drag link		1	NCA

(X) indicates rebuilt items sold exchange only. Please ship your part to be rebuilt. A number inside the () represents a core charge that is refunded once we receive your rebuildable core. Core charges are not applicable towards Free Ground Shipping total.

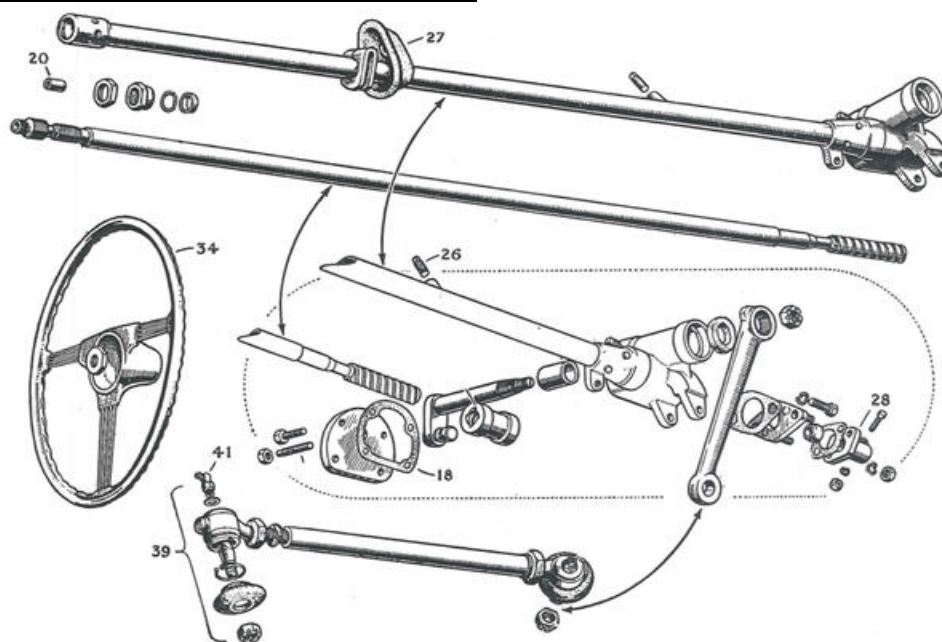

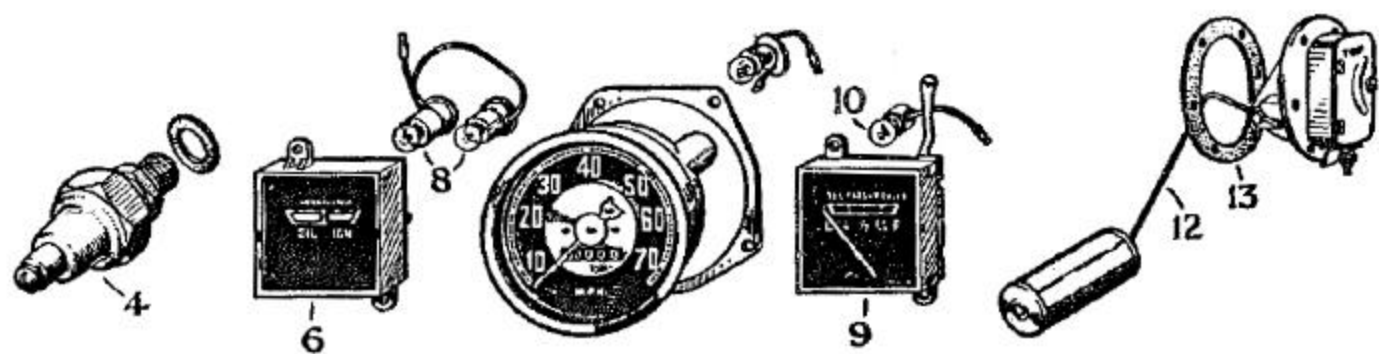

Dash Instruments (Above)

No	Part #	Description	Application	Qty Req	Price Each
	P.44100	Speedometer cable RHD		1	99.00
	P.79347	Speedometer cable LHD		1	96.00
4	P.44296	Oil pressure unit		1	22.69
6	P.44099	Oil and ignition warning light		1	NCA
8	K.18386	Bulb, oil and igiton warning light		2	1.88
9	P.44098	Petrol (gas) gauge		1	165.00
10	K.18386	Bulb, petrol gauge		1	1.88
12	P.66106	Tank unit		1	131.84
13	K.15510	Washer (gasket), tank unit		1	2.12

Lamps & Lenses (Below)

No	Part #	Description	Application	Qty Req	Price Each
14	K.19268	Dust excluder, headlamp		2	23.75
18	K.19273	Reflector and glass, headlamp		2	NCA
21	K.19267	Rim, headlamp		2	199.65
22	K.19274	Rubber gasket, headlamp		2	22.85
23	K.19083	Bulb-double filament, dipper		1	14.22
24	K.19085	Bulb-single filament, non-dipper		1	14.22
25	K.19270	Bulb-pilot		2	1.76
27	K.19083	Bulb-double filament, headlamp		2	14.22
29	K.14151	Glass, stop tail lamp		1	98.00
33	K.10191	Bulb, stop tail lamp		1	2.85
	P.41795	Stop tail lamp		1	228.69
39	K.10191	Bulb, stop tail lamp		1	2.85
42	K.10205	Bulb, roof lamp		1	14.83

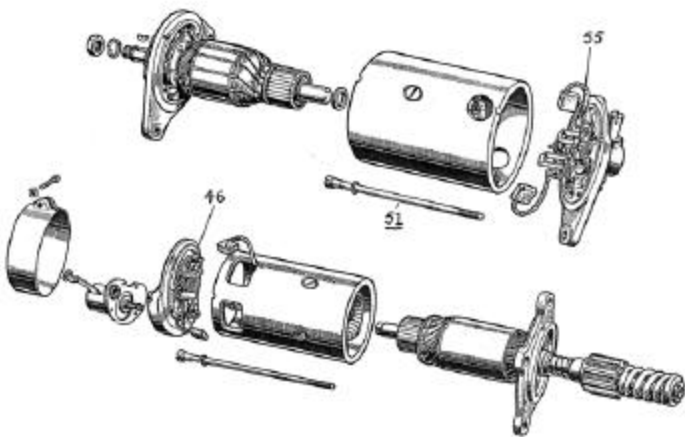
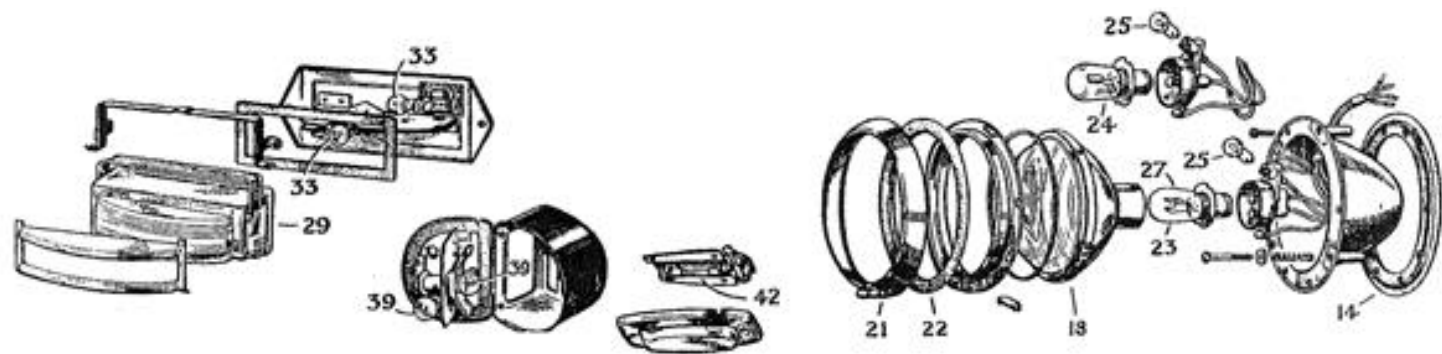

Starter (Left)

No	Part #	Description	Application	Qty Req	Price Each
	P.44310	Starter (X)		1	175.00
46	K.11330	Brushes, pair (starter)		1	30.56
51	P.44151	Dynamo, generator (X175) <		1	225.00

(X) indicates rebuilt items sold exchange only. Please ship your part to be rebuilt. A number inside the () represents a core charge that is refunded once we receive your rebuildable core. Core charges are not applicable towards Free Ground Shipping total.

Ignition (Left)

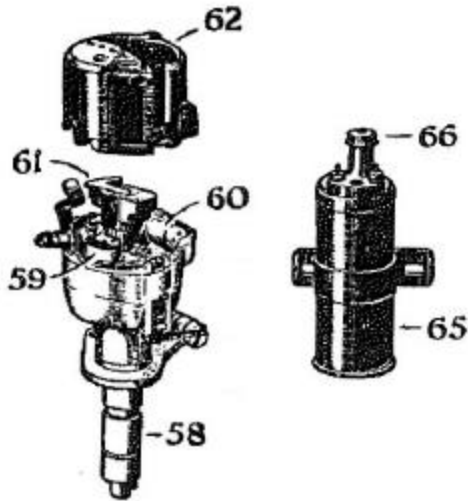

No	Part #	Description	Application	Qty	Cost
58	P.42721	Distributor (X)		1	465.00
59	K.14070	Contact set		1	29.35
60	K.18993	Condensor c/w plate		1	40.96
61	P.34868	Rotor assembly		1	23.90
62	K.14283	Distributor cap		1	122.00
65	P.42708	Ignition coil		1	127.05
66	K.6133	Moulded H.T. nut, ignition coil		1	3.33
	P.78395	Spark plug		4	5.25
	P.55617	High tension cable set		1	39.00
	P.81977	Harness, wiring for chassis LHD - fabric		1	815.00
	P.81977A	Harness, wiring for chassis LHD - tape		1	525.00
	K.15878	Cable, positive battery lead/ground		1	57.18
	P.82550	Harness, wiring for body - fabric	Coupe	1	275.00
	P.82550A	Harness, wiring for body - tape	Coupe	1	175.00
	P.81514	Harness, wiring for body - fabric	Saloon	1	275.00
	P.81514A	Harness, wiring for body - tape	Saloon	1	175.00
	K.17064	Cable, negative battery lead/starter		1	66.00
	P.82553	Harness, wiring for body - fabric	Utility	1	275.00
	P.82553	Harness, wiring for body - tape	Utility	1	175.00

(X) indicates rebuilt items sold exchange only. Please ship your part to be rebuilt. A number inside the () represents a core charge that is refunded once we receive your rebuildable core. Core charges are not applicable towards Free Ground Shipping total.

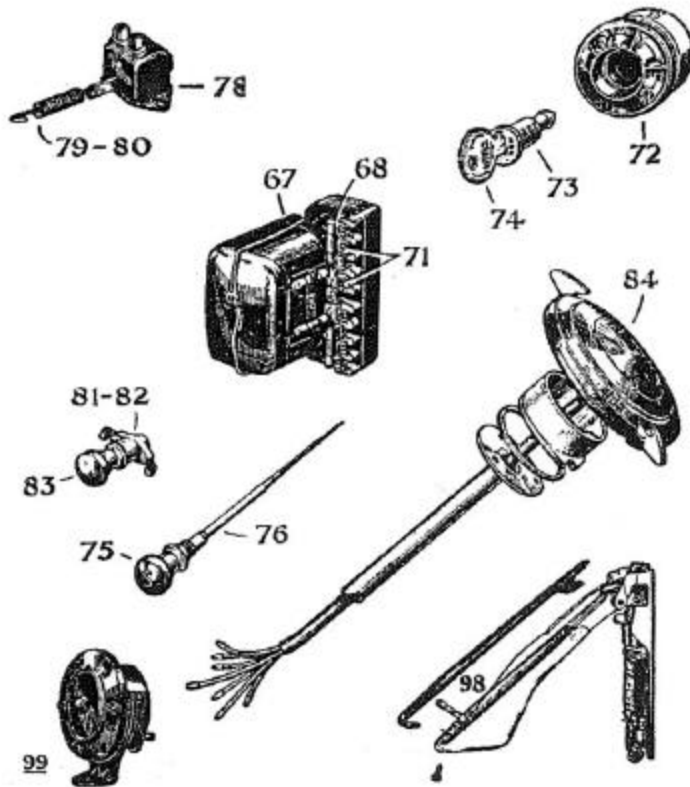

Switches (Left)

No	Part #	Description	Application	Qty	Cost
67	P.77257	Control box (X185) <		1	320.65
68	K.1563	Fuse, 25 amps		1	1.76
72	P.44082	Switch box (ignition and lighting)		1	272.25
73	P.42701	Ignition lock		1	13.25
74	H.74406	Key, ignition and door		2	22.00
75-76	K.19277	Starter control with knob,wire, body, and tube		1	96.00
77	P.42724	Starter switch		1	45.00
78	P.40381	Brake stop light switch		1	96.20
81	P.44140	Panel switch		1	55.00
82	P.44140	Screen wiper switch		1	55.00
83	K.19582	Knob, switch (wiper or panel)		2	28.00
84	K.19583	Steering column top cover c/w horn push (X)		1	289.00
	DKS-Minx	Dash knob set (panel, wiper, C, S)		1	97.50
99	P.41804	Horn		1	319.00
	SF40	Trafficator (X95)		2	225.00
98	K.10205	Bulb, trafficator		2	14.83

(X) indicates rebuilt items sold exchange only. Please ship your part to be rebuilt. A number inside the () represents a core charge that is refunded once we receive your rebuildable core. Core charges are not applicable towards Free Ground Shipping total.

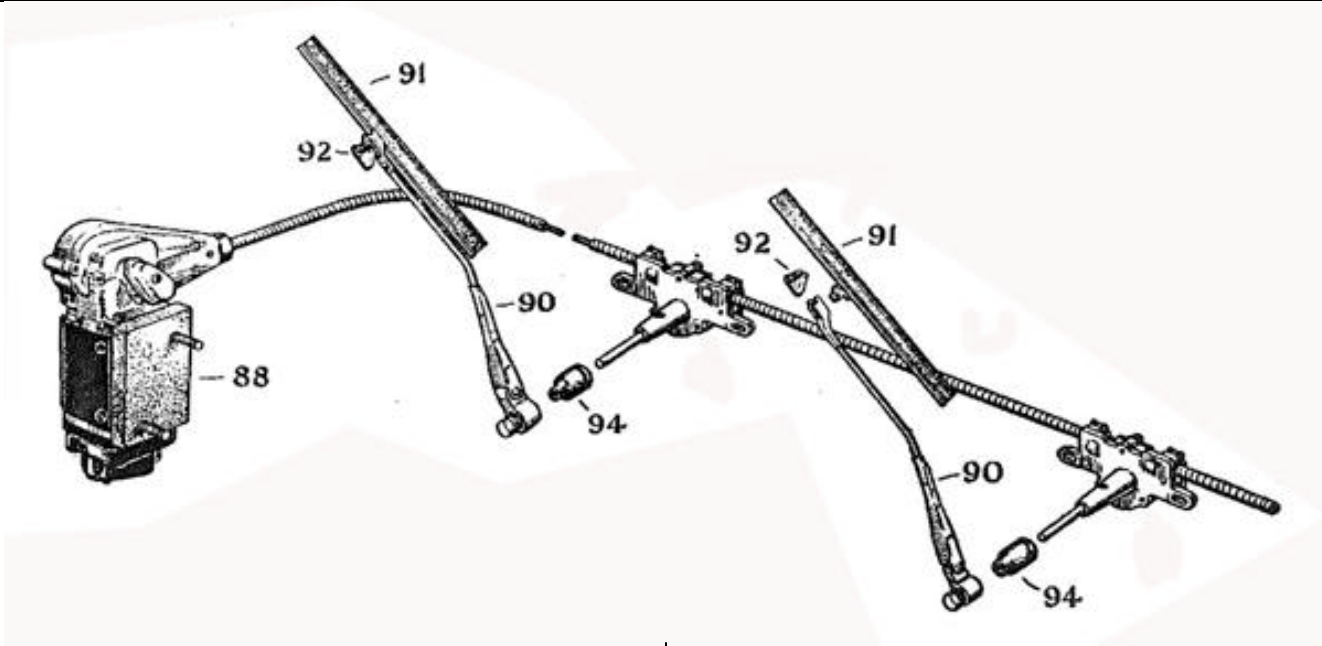

Screen Wiper (Above)

No	Part #	Description	Application	Qty Req	Price Each
88	K.19585	Motor unit (X95)		1	195.00
90	K.19586	Arm, wiper		2	NCA
91	K.13503	Blade, wiper		2	23.90
92	K.12194	Rubber peg-blad to arm		2	2.37
94	K.12197	Spindle grommet		2	NCA

NCA- not currently available; please inquire.

Suspension (Below)

No	Part #	Description	Application	Qty Req	Price Each
28	P.54869	Bushing-spring eye, front end	Saloon and Coupe	2	39.75
29	P.54544	Bushing- spring eye, rear end	Saloon and Coupe	2	41.14
35	P.54544	Bushing - shackle, front springs	bushed	2	41.14
45	P.65538	Bush, rear spring	bushed	4	41.14
54	P.79686	Clamp rubber-top, spring to axle casing		2	NCA
56	P.79688	Clamp rubber-bottom, spring to axle casing		2	NCA
61	P.65538	Bush-shackle, silentbloc for rear spring		2	41.14
	P.78750	Damper, front RH (X)		1	285.00
63	P.78751	Damper, front LH (X)		1	285.00
64	P.78752	Damper, rear RH (X)		1	285.00
65	P.78753	Damper, rear LH (X)		1	285.00
66	K.9875	Lever and link bearing-top (bushing, shock link upper)	4	9.99	
67	P.42877	Link bearing-bottom		4	9.99
	P.65354	Rebound strap RH		1	24.00
	P.65355	Rebound strap LH		1	24.00
	P.65356	Buffer, rear buffer bracket		2	NCA

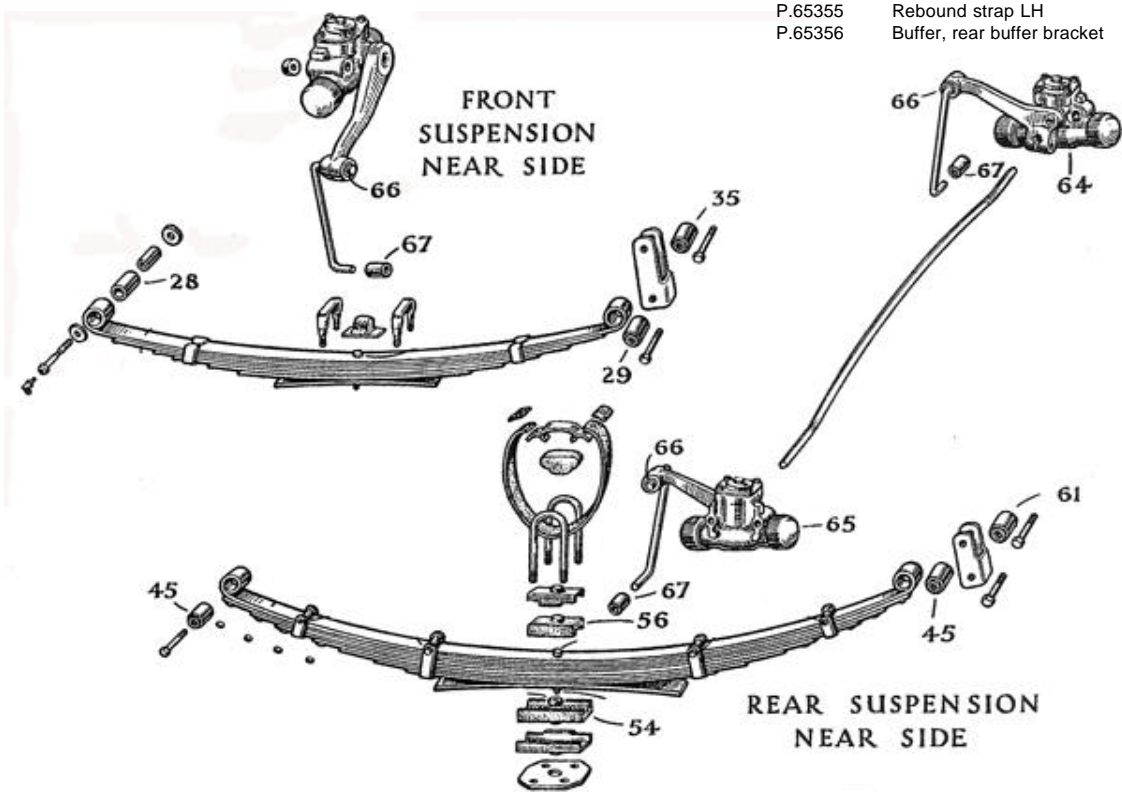

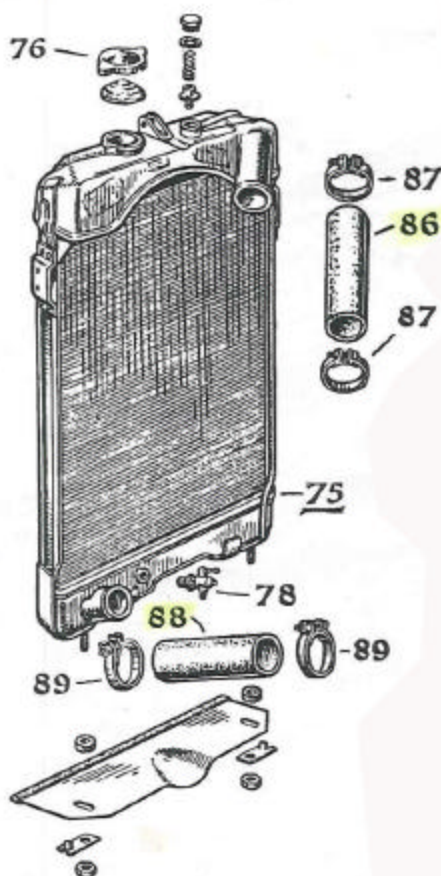

Radiator (Left)

No	Part #	Description	Application	Qty Req	Price Each
P.80614		Radiator block, recored (X)		1	695.00
76	P.78973	Filler cap assembly		1	19.25
78	P.42840	Drain tap		1	NCA
79	P.54178	Overflow valve		1	38.75
86	P.65283	Top water hose		1	18.75
87	P.38405	Clip, top hose		2	4.68
88	P.55873	Bottom water hose		1	8.25
89	P.56099	Clip, bottom hose		2	4.68

(X) indicates rebuilt items sold exchange only. Please ship your part to be rebuilt. A number inside the () represents a core charge that is refunded once we receive your rebuildable core. Core charges are not applicable towards Free Ground Shipping total.

NCA- not currently available; please inquire.

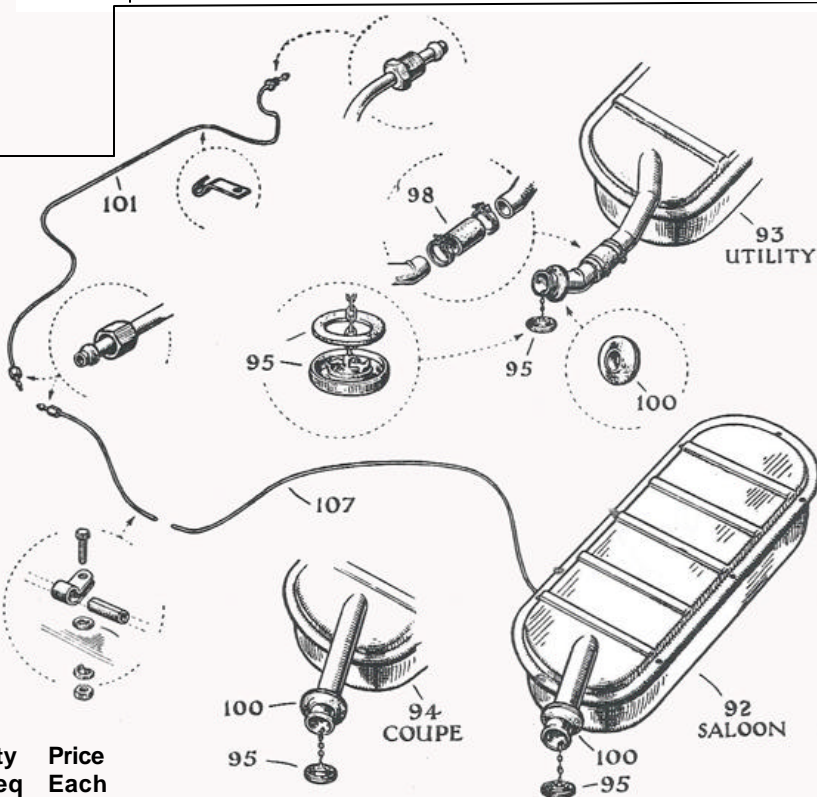

Petrol (Fuel) System (Right)

No	Part #	Description	Application	Qty Req	Price Each
92	P.78683	Gas tank assembly (X)	Saloon	1	425.00
93	P.65862	Gas tank assembly (X)	Utility	1	425.00
94	P.80954	Gas tank assembly (X)	Coupe	1	425.00
95	P.55695	Filler cap, gas tank		1	17.88
98	P.38461	Hose, filler extension		1	5.25
100	H.19335	Grommet, gas filler		1	26.32
101	P.65591	Gas pipe assembly, pump to carb		1	NCA
107	P.81554	Gas pipe complete, tank to pump		1	NCA

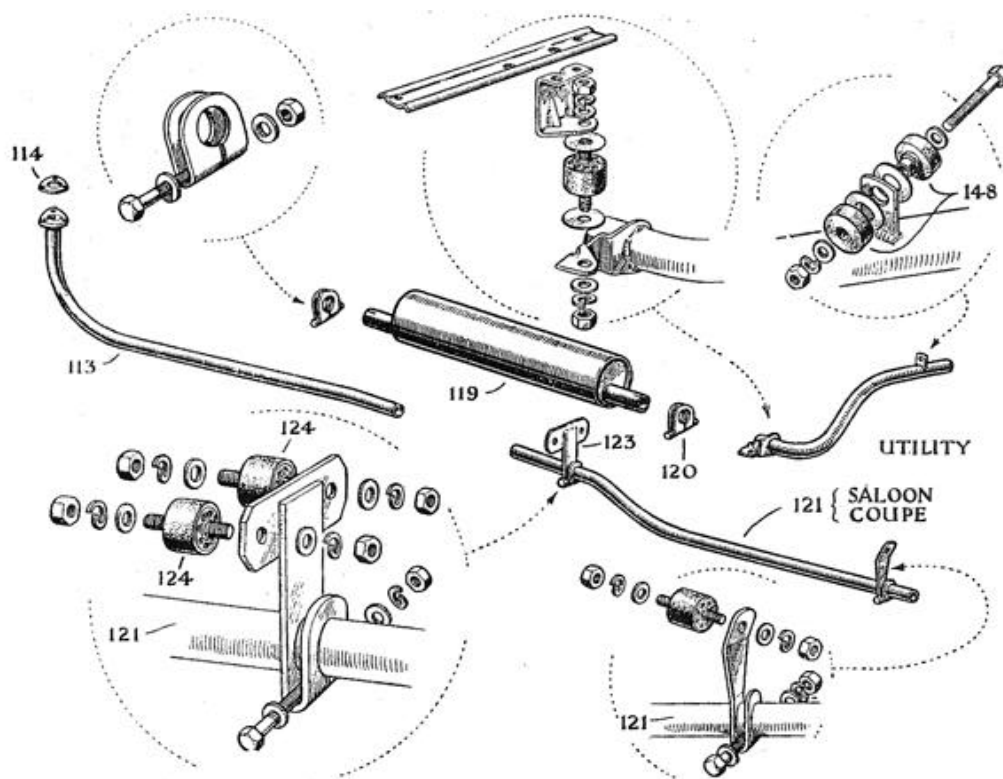

Exhaust System (Above)

No	Part #	Description	Application	Qty Req	Price Each
113	P.65818	Exhaust pipe assembly		1	NCA
114	P.38369	Joint, exhaust pipe		1	21.00
119	P.75036	Silencer (muffler)		1	185.00
120	P.78333	Clip, silencer		1	NCA
121	P.80753	Tail pipe	Saloon/Coupe	1	NCA
123	P.82503	Clip, tail pipe		1	NCA
124	P.65929	Insulator, tail pipe center hanger	Saloon/Coupe	2	NCA
148	P.65930	Insulator, tail pipe rear end	Utility	1	NCA
114	P.38369	Joint, exhaust pipe		1	21.00
119	P.75036	Silencer (muffler)		1	185.00
120	P.78333	Clip, silencer		1	NCA
121	P.80753	Tail pipe	Saloon/Coupe	1	NCA
123	P.82503	Clip, tail pipe		1	NCA
124	P.65929	Insulator, tail pipe center hanger	Saloon/Coupe	2	NCA
148	P.65930	Insulator, tail pipe rear end	Utility	1	NCA

NCA - not currently available; please inquire.

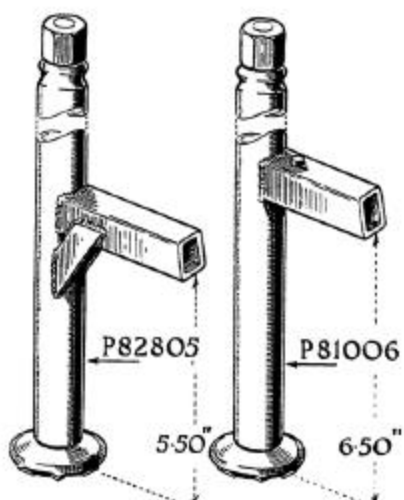

Tools (Left)

No	Part #	Description	Application	Qty Req	Price Each
	P.81006	Lifting Jack	Saloon and Coupe	1	NCA
	P.82805	Lifting Jack	Saloon and Coupe	1	NCA
	BSW-CW	British Standard Whitworth Combination wrench set - 7 pieces		1	245.00
		(1/8, 3/16, 1/4, 5/16, 3/8, 7/16, 1/2)			
		Open end wrench set - 4 pieces		1	125.00
		(1/8x3/16, 1/4x5/16, 3/8x 7/16, 1/2x9/16)			
		Box wrench set - 3 pieces		1	110.00
		(1/8x3/16, 1/4x5/16, 3/8x7/16)			
		Socket set, 3/8" drive - 7 pieces		1	175.00
		(1/8, 3/16, 1/4, 5/16, 3/8, 7/16, 1/2)			
		Socket set, 1/2" drive - 5 pieces		1	125.00
		(1/4, 5/16, 3/8, 7/16, 1/2)			
		British Association Open end wrench set - 6 pieces		1	85.00
		(0-10 BA)			

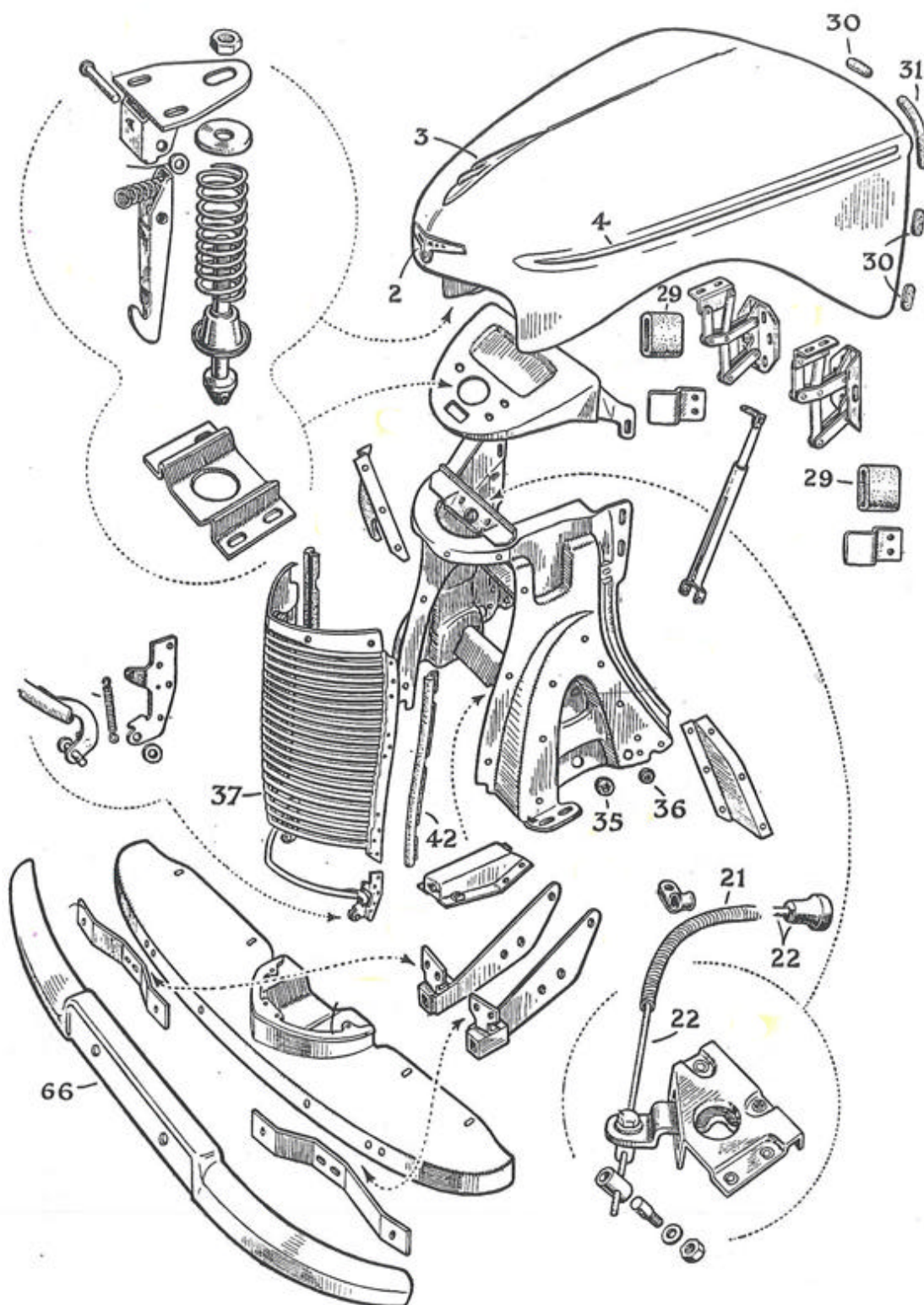

Body Mountings - Bonnet

No	Part #	Description	Application	Qty	Price
2	H.76341	Badge, bonnet		1	225.00
3	H.78410	Motif, bonnet		1	185.00
4	H.76952	Moulding, upper RH bonnet	Coupe	1	NCA
4	H.76953	Moulding, upper LH bonnet	Coupe	1	NCA
	H.76505	Clip, moulding to bonnet		26	2.85
21/22	K.19575	Lock, bonnet (body, tube, knob and wire)		1	135.00
29	H.62562	Sleeve, bonnet guide		2	13.75
30	H.61352	Rest rubbers, bonnet		6	3.85

No	Part #	Description	Application	Qty	Price
31	H.74690	Rest rubbers, bonnet dash corners		2	8.25
35	H.16861	Grommet-side panel mtg. cradle		1	7.25
36	H.16860	Grommet-headlamp cable-mtg. cradle		2	3.33
37	H.76401	Radiator grille assembly		1	3,900.00
42	H.76466	Rubber seal, radiator grille (18.5" each side)		1'	3.94
		Price is per foot.			
66	H.76425	Front bumper (X)		1	395.00
		(Send in your bumper to be rechromed)			

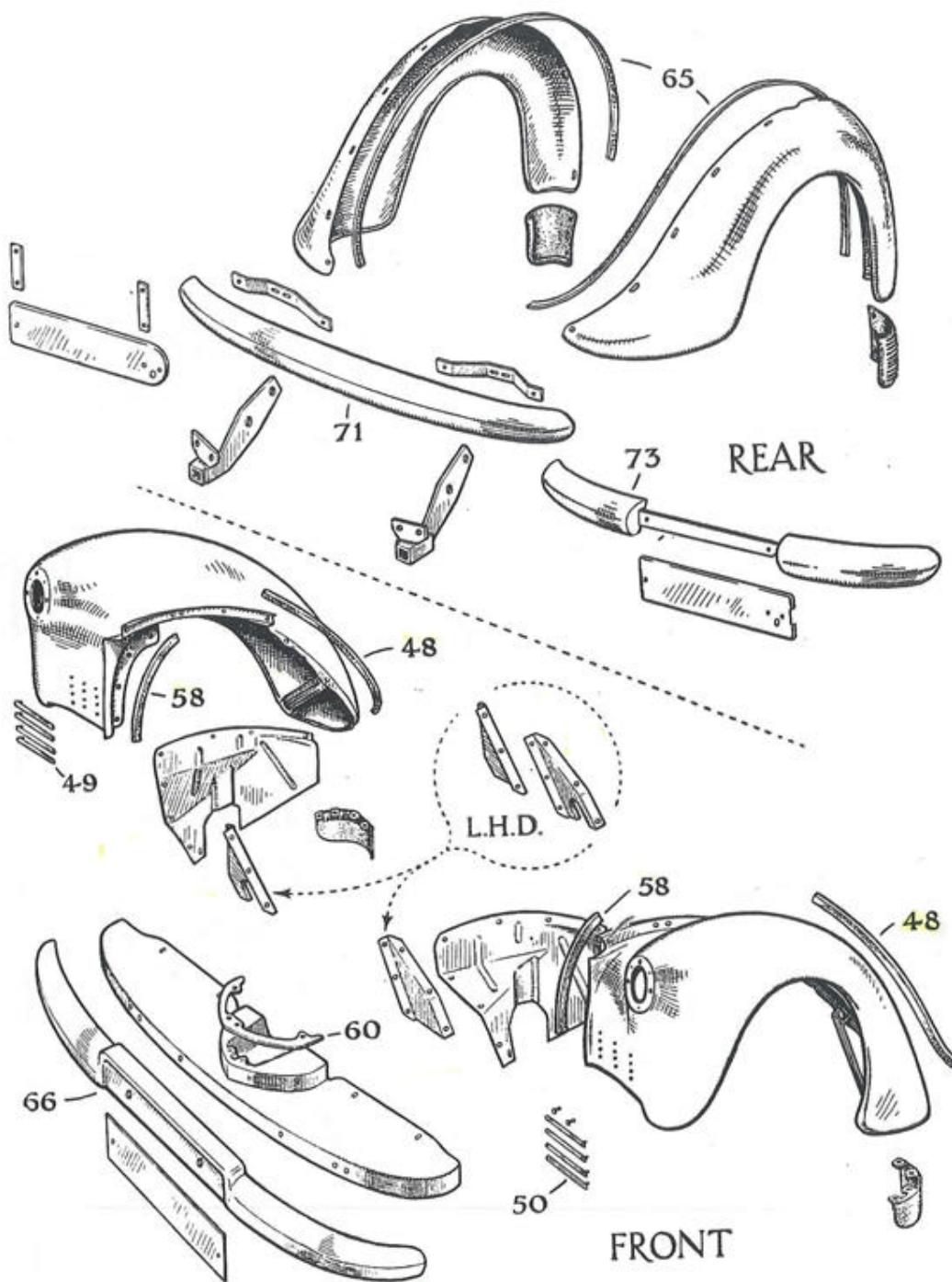

Body Mountings - Fendor

No	Part #	Description	Application	Qty Req	Price Each
48	H.79093	Piping, front wing (28" each wing) Price is per foot.		3	3.94'
49	H.76070	Moulding, RH front wing		4	95.00
50	H.76071	Moulding, LH front wing		4	95.00
58	H.79093	Piping, front wings to mounting cradle (18" long) Price is per foot		2	3.94'
60	H.76082	Cap, fairing, front wing to bumper		1	285.00
65	H.79093	Piping, rear wing (72" long) price per foot		6	3.94'
	H.23975	Mirror, wing driving RHD		1	33.25
	H.76761	Mirror, wing driving LHD		1	33.25
66	H.76425	Front bumper (X) Please send in your bumper to be rechromed.		1	395.00

No	Part #	Description	Application	Qty Req	Price Each
	H.42893	Coach bolt, front bumper		2	17.25
71	H.76426	Rear bumper (X)	Saloon	1	395.00
73	H.80924	Rear bumper (X) Please send in your rear bumper to be re-chromed	Coupe	1	395.00

(X) indicates rebuilt items sold exchange only. Please ship your part to be rebuilt. A number inside the () represents a core charge that is refunded once we receive your rebuildable core. Core charges are not applicable to free shipping rate.

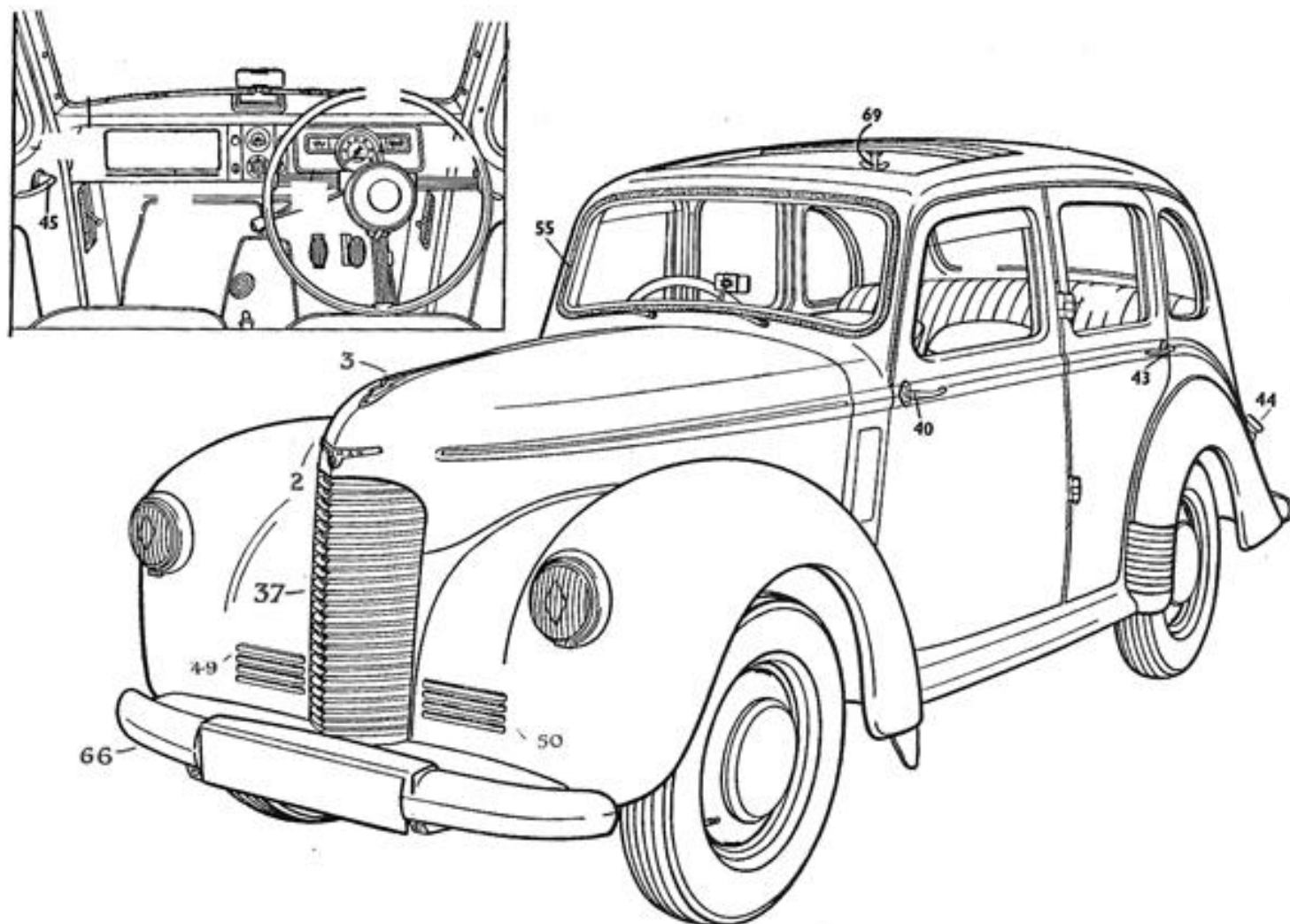

Saloon Front Body Fittings

No	Part #	Description	Application	Qty Req	Price Each	No	Part #	Description	Application	Qty Req	Price Each
2	H.76341	Badge, bonnet	Saloon	1	225.00	45	H.76669	Door handle, interior LH (front and rear door)	Saloon	2	86.00
3	H.78410	Motif, bonnet	Saloon	1	185.00		H.76668	Door handle, interior RH (front and rear door)	Saloon	2	86.00
	H.19727	Scuttle vent weather-strip	Saloon	2	28.00				Saloon	2	86.00
	H.19699	Door buffer	Saloon		16.04		H.60078	Escutcheon (need pattern to reproduce)	Saloon	4	43.50
	H.63579	Glazing rubber bead tape	Saloon	price/foot	2.00		H.17995	Retainer	Saloon	4	1.88
		Price is per foot. Please measure.				44	P.105757	Fuel filler cap, Hillman	Saloon	1	17.88
37	H.76401	Radiator grille assembly	Saloon	1	3900.00	49	H.76070	Moulding, RH front wing	Saloon	4	95.00
	H.74704	Front door handle, exterior locking RH	Saloon	1	175.45	50	H.76071	Moulding, LH front wing	Saloon	4	95.00
40	H.74713	Front door handle, exterior non locking	Saloon	1	163.35	55	H.19477	Weather strip, front windscreen (108" long)	Saloon	1	92.00
43	H.74713	Rear door handle, exterior non locking	Saloon	2	163.35		H.63579	Glazing rubber bead tape, front windscreen (108" long)	Saloon	9	18.00*
								Price per foot	Saloon		
						66	H.76425	Front bumper (X)	Saloon	1	395.00
								Please send in your bumper to be rechromed.			

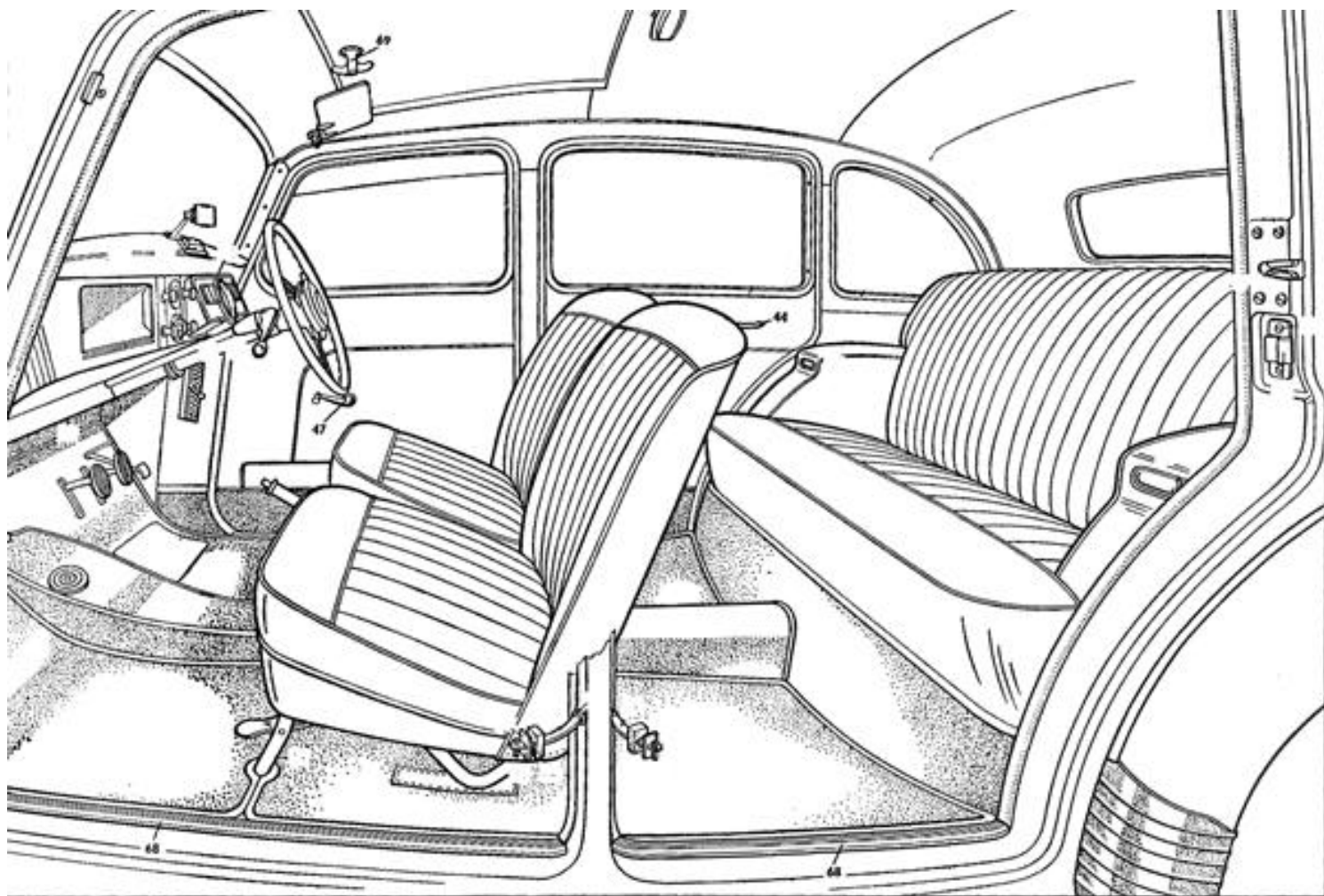

Saloon Interior Body Fittings

No	Part #	Description	Application	Qty Req	Price Each
	H.25047	Glass channel - top (30" long), front door. Price/foot		3'	1.75'
	H.73718	Glass channel - shut, RH, front door. Please measure and order # of feet required.	Price/foot		1.75'
	H.73719	Glass channel - pillar, LH, front door. Please measure and order # of feet required.	Price/foot		1.75'
	H.73720	Glass channel - hinge pillar front door. Please measure and order # of feet required.	Price/foot		1.75'
	H.76378	Glass run channel assy - shut RH front door		1	NCA
	H.76379	Glass run channel assy - pillar LH front door		1	NCA
	H.76387	Glass run channel assy - hinge pillar front door		2	NCA
	H.25044	Glass beading tape, front window (23")		1	2.54
47	H.76668	Door handle, interior RH (front and rear door)		2	86.00
	H.76798	Window regulator handle LH front door		2	74.00
	H.60078	Escutcheon, front door (need pattern to reproduce)		2	43.50
	H.17995	Retainer, front door		2	1.88
	H.25047	Glass channel, upper, rear door		2	NCA
	H.73721	Glass channel, hinge pillar, rear door		2	NCA
	H.73722	Glass channel, shut pillar, rear door		2	NCA
	H.76390	Glass channel assy-hinge pillar, rear door		2	NCA
	H.76394	Glass channel assy-shut pillar, rear door		2	NCA
	H.25044	Glass beading tape, rear window (22")		1	2.54
44	H.76798	Window regulator handle rear door (need pattern to reproduce)		2	74.00

No	Part #	Description	Application	Qty Req	Price Each
	H.60078	Escutcheon, rear door (need pattern to reproduce)		2	43.50
	H.17995	Retainer, rear door		2	1.88
	H.73176	Glazing channel, back light glass (72" long)		1	54.00
68	H.64124	Rubber door tread, (front 27" rear 10") Please measure and order # of feet required		price/foot	2.00'
69	H.60080	Locking handle, Sliding Lid		1	69.00
	H.73177	Weatherstrip, rear sliding lid (26")		1	17.85

SALOON - UPHOLSTERY

	CP-HM1A	Carpet set, BLUE*	Saloon	1	325.00
	CP-HM1B	Carpet set, BROWN*	Saloon	1	325.00
	H.52047A	Door frame piping, BLUE* Please measure and order # of feet required.		Price/foot	9.50'
	H.52047B	Door frame piping, BROWN* Please measure and order # of feet required.		Price/foot	9.50'
68	H.64124	Rubber door tread, (front 27" rear 10"). Please measure and order # of feet required.		Price/foot	19.25'

*Original Saloon Colour Schemes: Black with Brown upholstery, Cotswold Grey with Brown Upholstery, and Smoke with Aero Blue Upholstery. Fabric swatches available upon request. (Exterior color/interior color)

For upholstery, unfortunately we do not have any patterns. Please call if you desire upholstery; your original will be required to manufacture a new interior. Vinyl or leather.

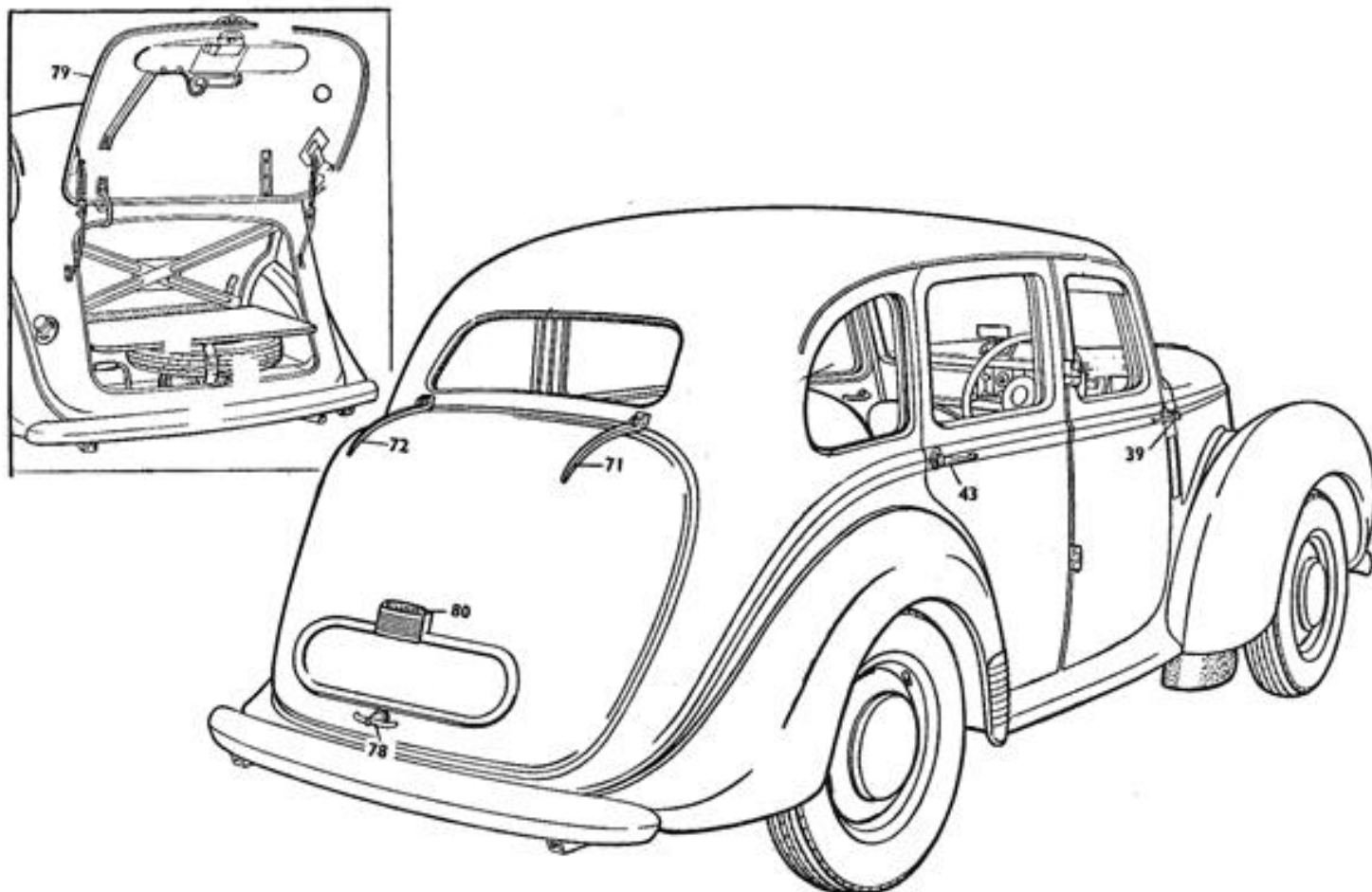

Saloon Rear Body Fittings

No	Part #	Description	Application	Qty Req	Price Each	No	Part #	Description	Application	Qty Req	Price Each
39	H.74704	Front door handle, exterior locking RH	Saloon	1	175.45		H.74950	Hinged pad, rubber trunk lid (need pattern to reproduce)	Saloon	2	NCA
43	H.74713	Rear door handle, exterior non locking	Saloon	2	163.35	78	H.74720	Handle, trunk lid (long shaft)	Saloon	1	211.75
71	H.61374	Hinge, trunk lid RH (need pattern to reproduce)	Saloon	1	NCA	79	H.76347	Trunk weatherstrip seal (140")	Saloon	1	176.44
72	H.61375	Hinge, trunk lid LH (need pattern to reproduce)	Saloon	1	NCA	80	H.76361	Badge, trunk lid "Hillman"	Saloon	1	225.00
							H.76426	Rear bumper (X)	Saloon	1	395.00

Please send in your rear bumper to be re-chromed.

NCA- not currently available. please inquire.

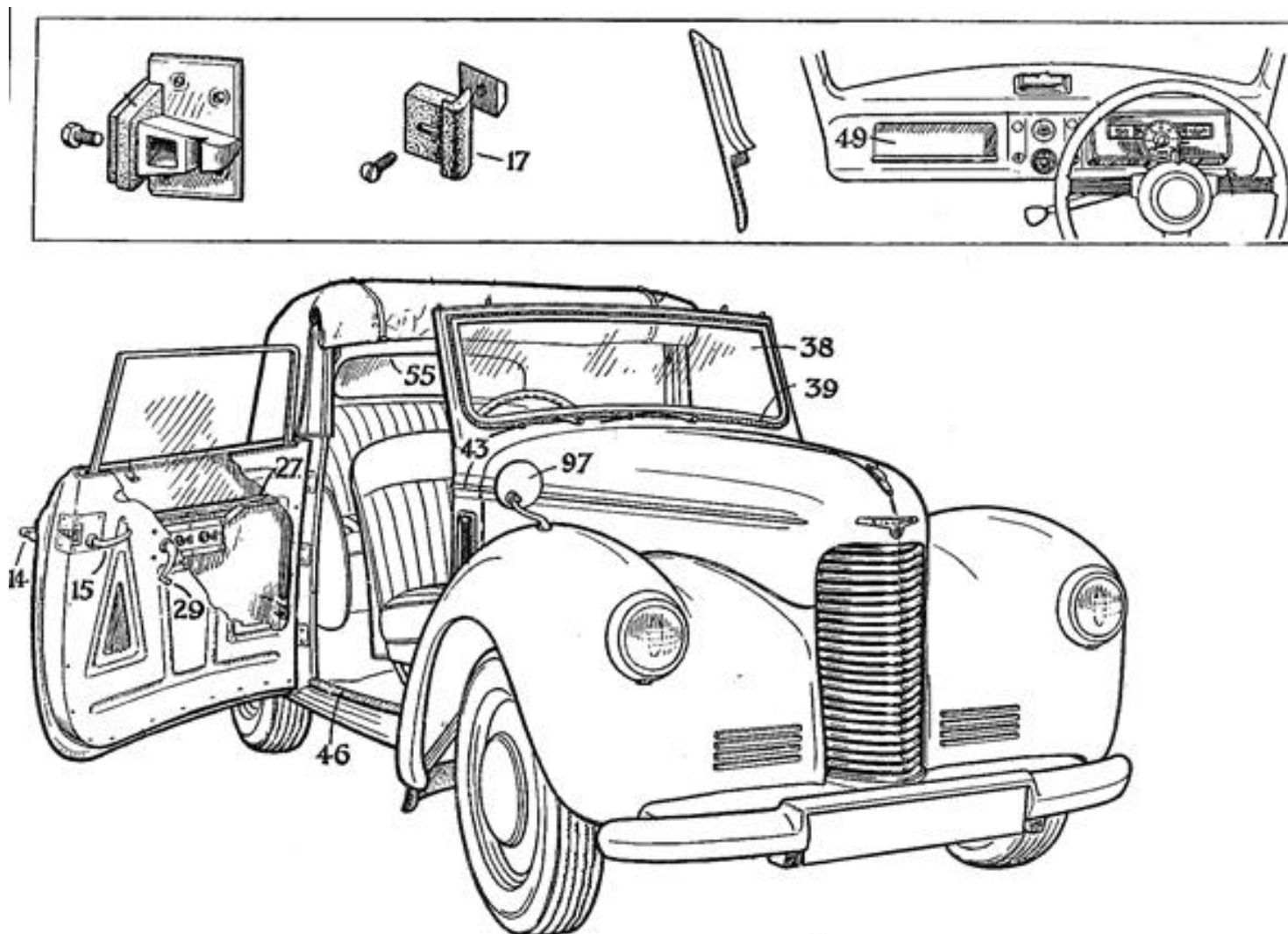
**Coupe Front Body Fittings**

No	Part #	Description	Application	Qty Req	Price Each
2	H.76341	Badge, bonnet	Coupe	1	225.00
3	H.78410	Motif, bonnet	Coupe	1	185.00
4	H.76952	Moulding, upper RH bonnet	Coupe	1	NCA
4	H.76953	Moulding, upper LH bonnet	Coupe	1	NCA
	P.105757	Fuel filler cap, Hillman	Coupe		17.88
	H.19727	Scuttle vent weather-strip	Coupe	2	28.00
14	H.74984	Outside locking handle	Coupe	1	185.00
	H.74985	Outside non-locking handle	Coupe		175.00
15	H.76668	Inside door handle RH	Coupe	2	86.00
	H.76669	Inside door handle LH	Coupe	2	86.00
	H.60078	Escutcheon	Coupe	4	43.50
		(need pattern to reproduce)			
	H.17995	Retainer	Coupe	4	1.88
17	H.19699	Door buffer	Coupe	4	16.04
27	H.77814	Glazing rubber, window frame (38")		Price/foot	2.00'
		Please measure and order # of feet required.			
	H.63579	Glazing rubber, window frame (120")		Pice/foot	2.00'
		Please measure and order # of feet required.			
29	H.75077	Handle, window regulator	Coupe	2	74.00
		(need pattern to reproduce)			
	H.75078	Escutcheon	Coupe	2	43.50
		(need pattern to reproduce)			

No	Part #	Description	Application	Qty Req	Price Each
37	H.76401	Raditor grille assembly	Coupe	1	3,900.00
38	H.63579	Glazing rubber, front windscreen (108" long)		Price/foot	2.00'
39	H.74338	Weatherstrip, front windscreen (112" long)		1	101.00
40	H.80781	Windscreen top rail rubber weatherstrip		Price/foot	19.25'
41	H.80775	Windscreen pillar weatherstrip		Price/foot	8.00'
43	H.80786	Scuttle bead, cowl RH	Coupe	1	55.66
	H.80787	Scuttle bead, cowl LH	Coupe	1	55.66
	H.80766	Door bead, RH (not shown)	Coupe	1	NCA
	H.80767	Door bead, LH (not shown)	Coupe	1	NCA
45	H.80788	Quarter panel bead, RH	Coupe	1	NCA
	H.80789	Quarter panel bead, LH	Coupe	1	NCA
46	H.77604	Sill tread rubber (39" long)	Coupe	A/R	62.50
49	H.76350	Cubby box assembly, RHD	Coupe	1	85.00
	H.76351	Cubby box assembly, LHD	Coupe	1	85.00
	H.76355	Rubber sealing stip, facia panel (40" long)		Price/foot	5.25'
55	H.78544	Glass, backlight	Coupe	1	295.00
		includes inner, outer frame, and sealing rubber.			
66	H.76425	Front bumper (X)	Coupe	1	395.00
		Please send in your bumper to be re-chromed.			

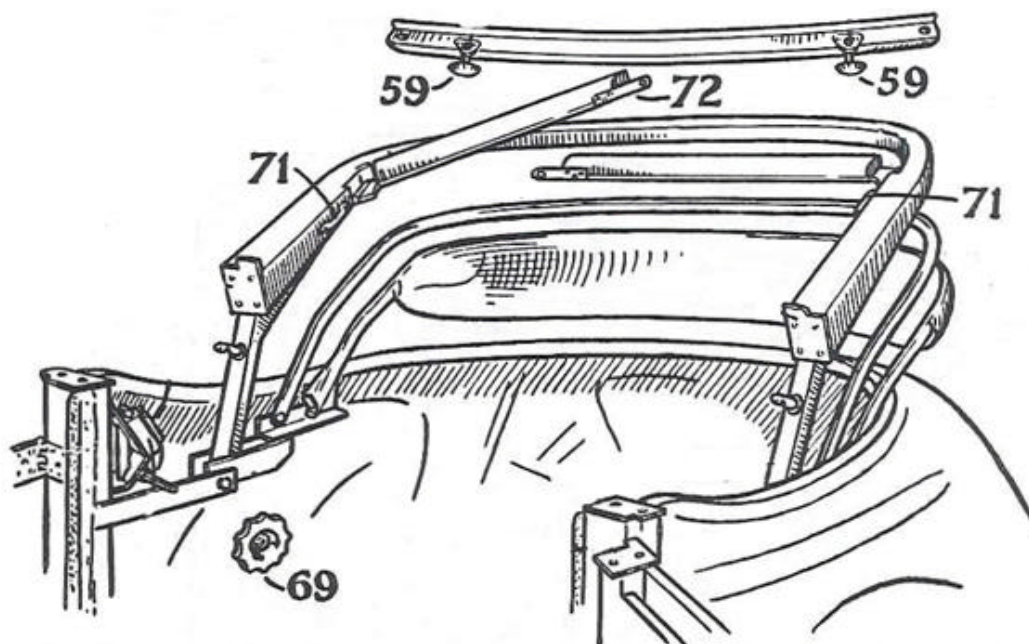

Coupe Folding Top

No	Part #	Description	Application	Qty Req	Price Each
	C-HM1	Top, folding head - canvas	Coupe	1	699.00
54, 55	H.78544	Glass, backlight includes inner, outer frame, and sealing rubber.	Coupe	1	295.00
59	H.80780	Knob, head rail lock	Coupe	2	49.75

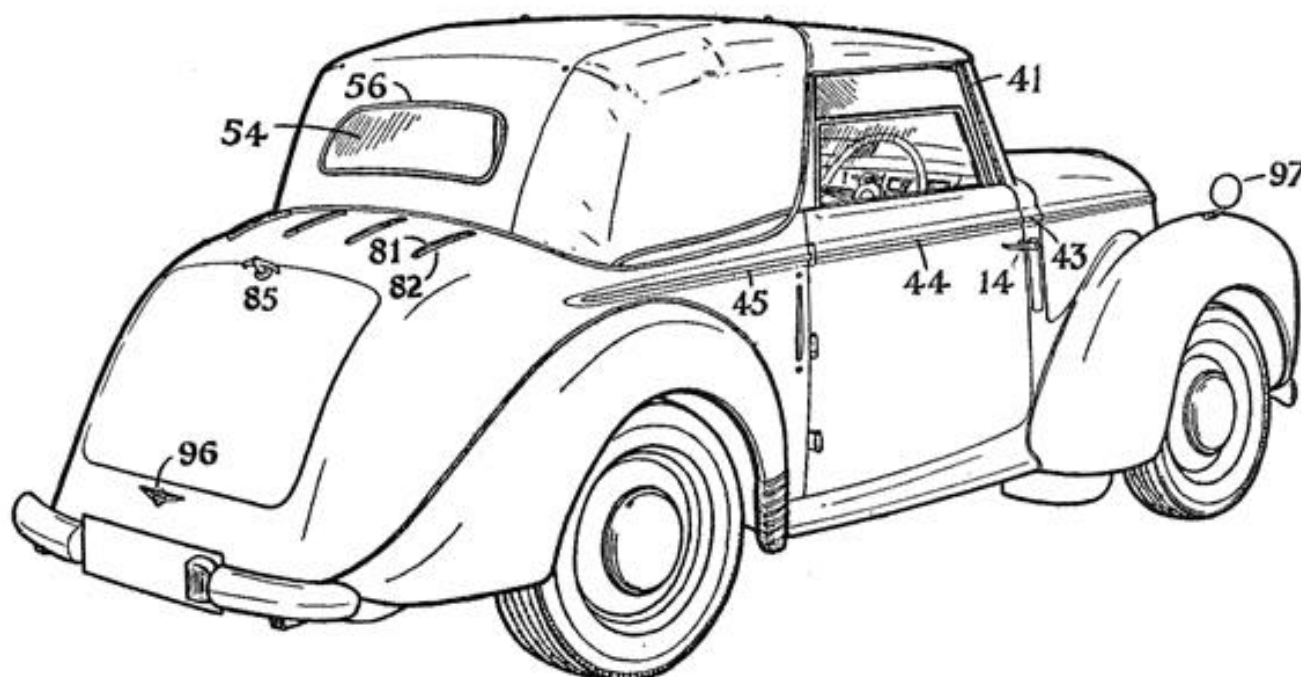

Coupe Rear/Exterior Body Fittings

No	Part #	Description	Application	Qty Req	Price Each	No	Part #	Description	Application	Qty Req	Price Each
14	H.74984	Outside locking handle	Coupe	1	185.00	54, 55	H.80789	Quarter panel bead, LH	Coupe	1	NCA
41	H.80775	Windscreen pillar weatherstrip	Coupe	1	19.75		H.78544	Glass, backlight includes inner, outer frame, and sealing rubber.	Coupe	1	295.00
	C-HM1	Top, folding head - canvas	Coupe	1	699.00	81	H.75652	Folding top rest rubber (9" long)		1	16.23
43	H.80786	Scuttle bead, cowl RH	Coupe	1	55.66	82	H.75651	Surround, top rest rubber	Coupe	4	71.50
	H.80787	Scuttle bead, cowl LH	Coupe	1	55.66	85	H.74347	Handle, trunk lid	Coupe		211.75
44	H.80766	Door bead, RH	Coupe	1	NCA	96	H.61348	Badge, trunk lid	Coupe	1	225.00
	H.80767	Door bead, LH	Coupe	1	NCA	97	H.23975	Wing driving mirror, complete RHD		1	33.28
45	H.80788	Quarter panel bead, RH	Coupe	1	NCA	NCA- not currently available; please inquire.					

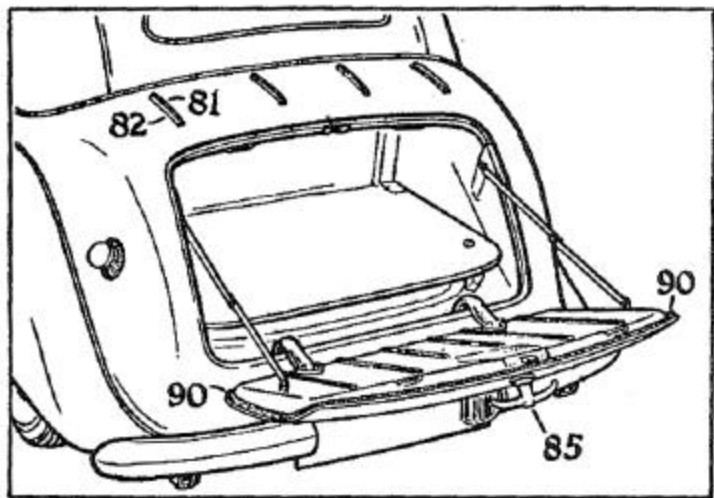

Coupe Trunk (Left)

No	Part #	Description	Application	Qty Req	Price Each
81	H.75652	Folding top rest rubber (9" long)	Coupe	1	16.23
82	H.75651	Surround, top rest rubber	Coupe	4	71.50
85	H.74347	Handle, trunk lid	Coupe	1	211.75
90	H.80847	Trunk weatherstrip seal (116")	Coupe	1	118.00
	H.61348	Badge, trunk lid	Coupe	1	225.00

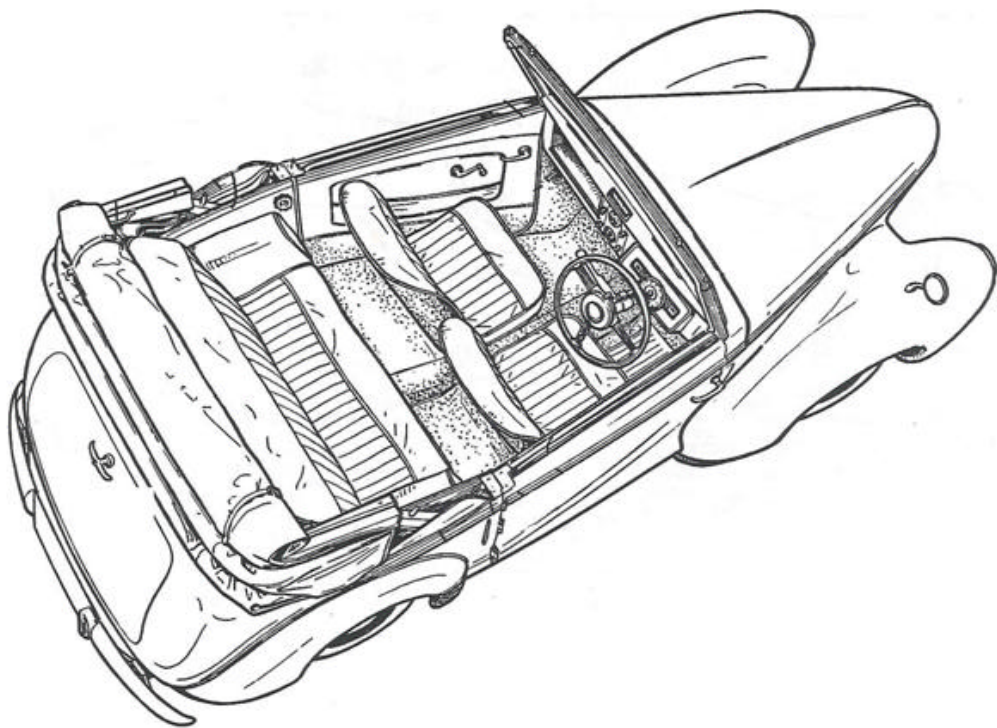

Coupe Upholstery and Carpet Sets

No	Part #	Description	Application	Qty Req	Price Each
UK-HM1		Upholstry kit, vinyl (Brown or Aero Blue)		1	1,025.00
UK-HM1L		Upholstry kit leather (Brown or Aero Blue)		1	2,125.00
PK-HM1		Panel kit (Brown or Aero Blue)	Coupe	1	1,177.94
CP-HM2		Carpet set (Brown or Aero Blue)		1	325.00
H.77604		Sill tread rubber (39") long	Coupe	1	62.50
C-HM1		Top, canvas	Coupe	1	698.78
H.52047A		Door frame piping, BLUE. Please measure and order # of feet required.		Price/foot	9.50'
H.52047B		Door frame piping, BROWN. Please measure and order # of feet required.		Price/foot	9.50'

NOTE: Drophead Coupe Original Colour Schemes: Black with Brown upholstery or Smoke (grey) with Aero Blue upholstery. Color swatches available upon request.

Upholstery kits includes vinyl or leather upholstery for two front seats/back and bench seat/back plus wheelhouse covers.

Panel kits includes all interior panels, clips and screws required for one vehicle.

Carpet set includes all interior front and back carpet for one vehicle.

Door piping is sold seperately; price is by the foot.

Upholstry Tools:		
TL-HRP	Hog ring pliers	1
FN-PR	Pig rings, box	1
SB-CB-B	Seat belt, black	4

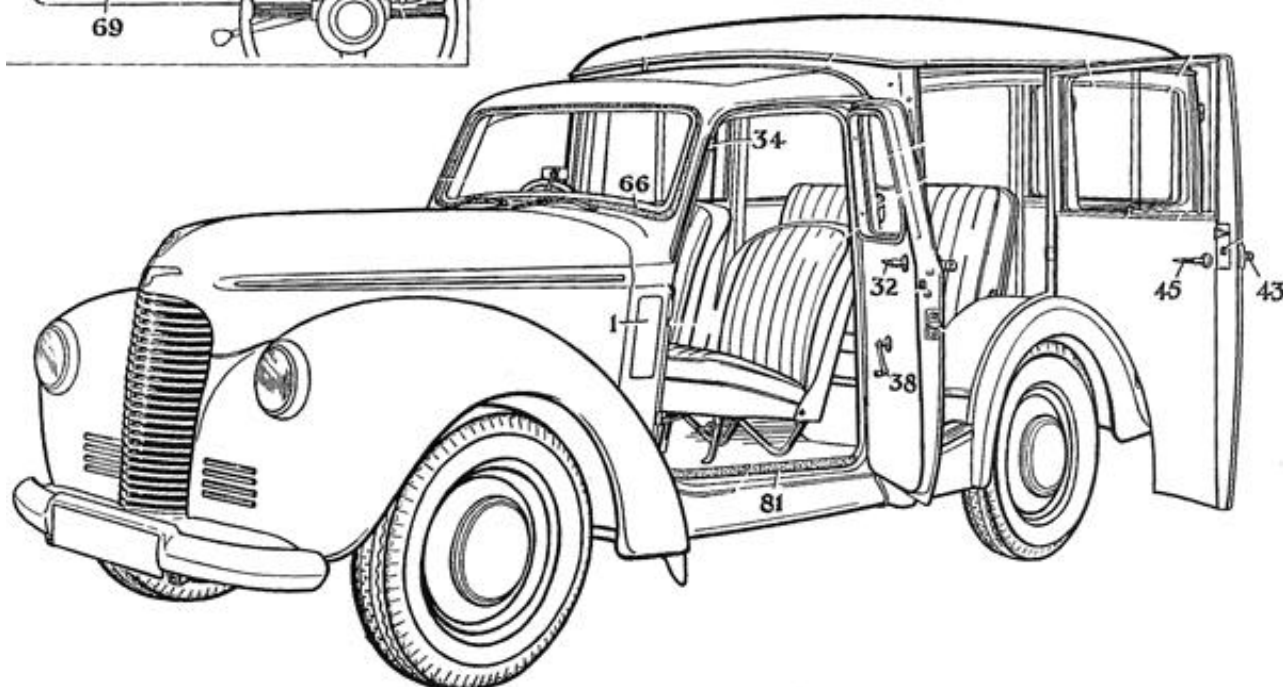
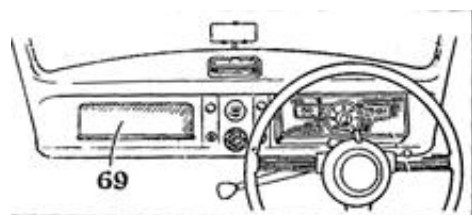

Utility Front/Exterior/Interior Body Fittings

No	Part #	Description	Application	Qty Req	Price Each	No	Part #	Description	Application	Qty Req	Price Each
1	H.19727	Scuttle vent weatherstrip	Utility	2	28.00		H.25044	Glazing weatherstrip, front window (23")	Price/foot	2.00'	
	H.74704	Locking handle, front door RH	Utility	1	175.45			Please measure and order # of feet in required.			
31	H.74713	Non-locking handle, front door LH	Utility	1	163.35	38	H.76798	Window regulator handle LH front door		2	74.00
32	H.76668	Inside handle, front door RH	Utility	2	86.00		H.60078	Escutcheon, front door		2	43.50
	H.76669	Inside handle, front door LH	Utility	2	86.00			(need pattern to reproduce)			
	H.60078	Escutcheon	Utility	4	43.50		H.17995	Retainer, front door		2	1.88
		(need pattern to reproduce)				43	H.80254	Outside handle, rear passenger door		2	165.35
	H.17995	Retainer	Utility	4	1.88		H.74724	Inside handle, rear passenger RH		2	86.00
34	H.19699	Door buffer	Utility	4	16.04	45	H.74725	Inside handle, rear passenger LH		2	86.00
	H.73718	Glass channel - Shut, RH, front door		Price/foot	1.75'		H.60078	Escutcheon	Utility	2	43.50
		Please measure and order # of feet in required.						(need pattern to reproduce)			
	H.73719	Glass channel - pillar, LH, front door		Price/foot	1.75'		H.17995	Retainer	Utility		1.88
		Please measure and order # of feet in required.				66	H.19477	Weather strip, front windscreen (108" long)		1	92.00
	H.73720	Glass channel - hinge pillar front door		Price/foot	1.75'		H.63579	Glazing rubber, front windscreen (108" long)	Price/foot		2.00'
		Please measure and order # of feet in required.						Please measure and order # of feet required.			
	H.25047	Glass channel - top (30" long), front door		Price/foot	1.75'		H.76355	Rubber sealing strip, facia panel (40")	Price/foot		5.25'
		Please measure and order # of feet in required.						Enter the number of feet required.			
	H.76378	Glass run channel assy - shut RH front door		1	NCA	69	H.76350	Cubby box assembly, RHD	Utility	1	85.00
	H.76379	Glass run channel assy - pillar LH front door		1	NCA		H.76351	Cubby box assembly, LHD	Utility	1	85.00
	H.76384	Glass run channel - hing pillar	Utility	1	NCA						

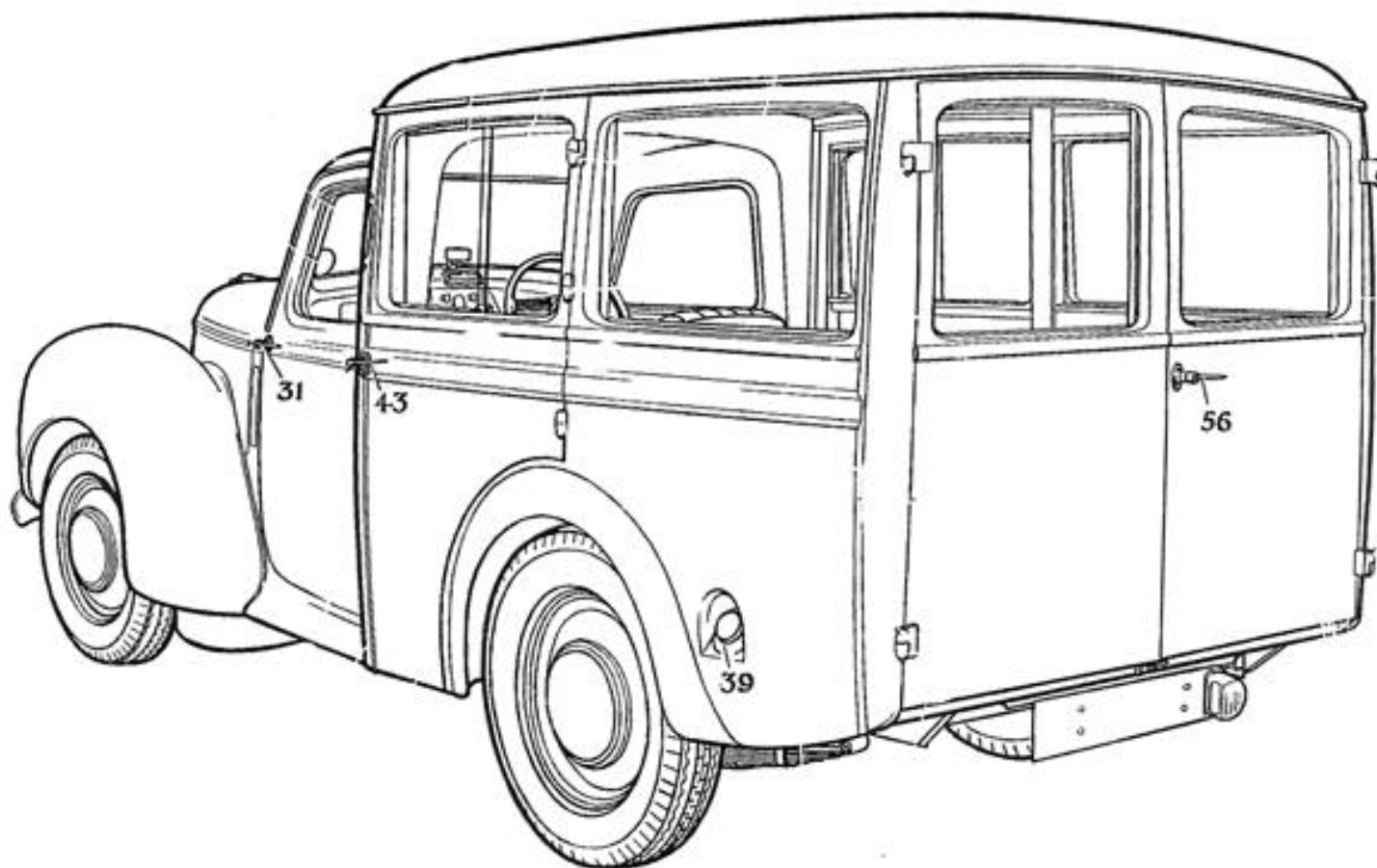

Utility Exterior

No	Part #	Description	Application	Qty Req	Price Each
31	H.74713	Non-locking outside handle, front door LH		1	163.35
	H.74704	Locking outside handle, front door RH			175.45
39	P.105757	Fuel filler cap, Hillman Utility			17.88
43	H.80254	Outside handle, rear passenger door (Left and Right)			163.35
	H.75823	Channel, glass sliding rear door (Slide 26", upright 18")	Price/foot Price/oof		1.75'
56		Van door exterior handle (need pattern to reproduce)		1	NCA

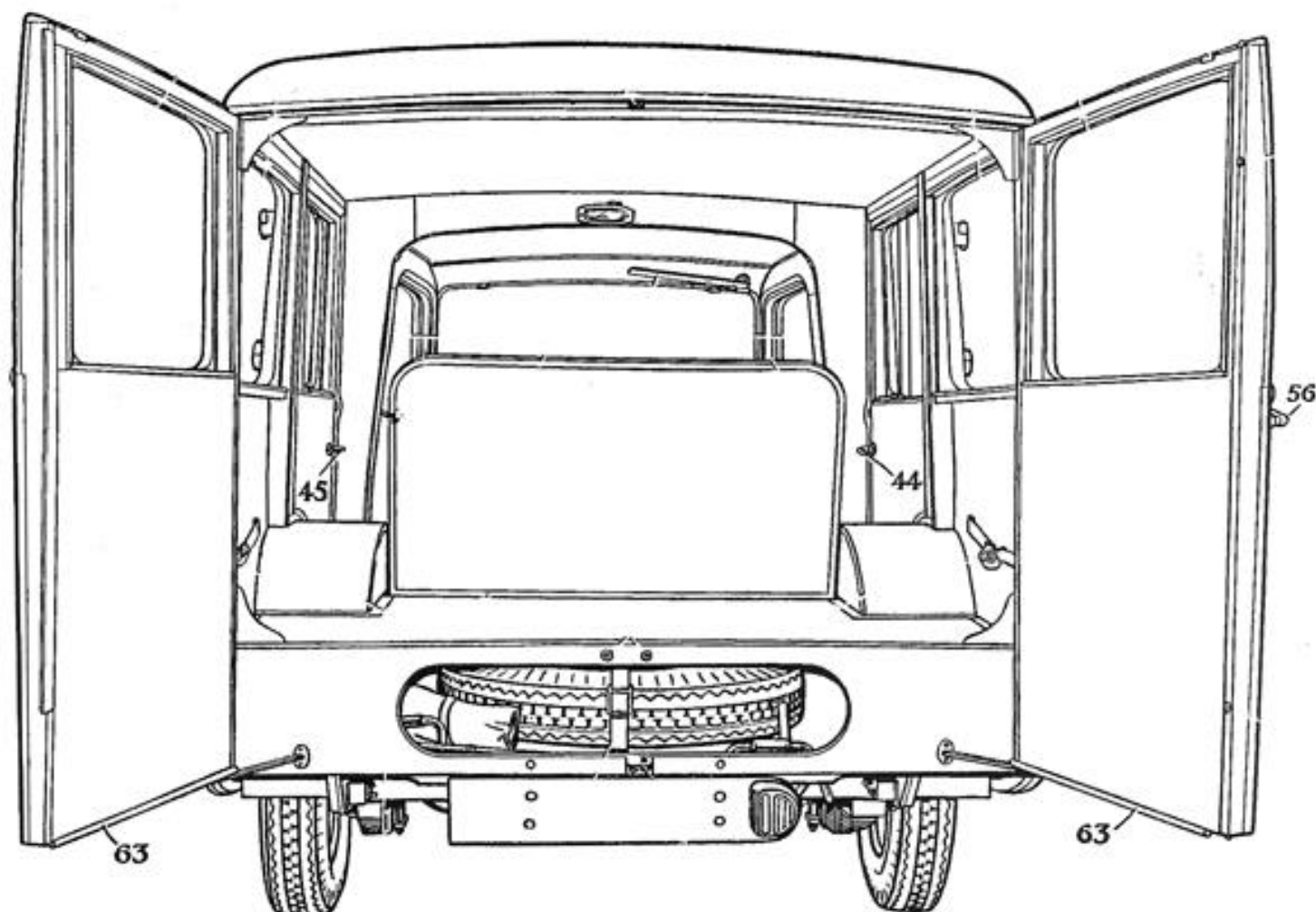

Utility Rear/Interior Body Fittings

No	Part #	Description	Application	Qty Req	Price Each	No	Part #	Description	Application	Qty Req	Price Each
	H.19699	Door buffer, rear passenger door			16.04		H.60649B	Piping (108") price per foot, BROWN			
44	H.74724	Inside handle, rear passenger RH		4	175.45			Please measure and order # of feet required. 10'			9.50'
45	H.74725	Inside handle, rear passenger LH		4	163.5		H.52047A	Piping, cab and side doors, BLUE Price is per foot.			
	H.60078	Escutcheon		1	43.5			Please measure and enter # of feet required.			9.50'
	H.17995	Retainer		1	1.88		H.52047B	Piping, cab and side doors, BROWN Price is per foot.			
56		Van door exterior handle		1	NCA			Please measure and order # of feet required.			9.50'
		(need pattern to reproduce)					H.79449	Wing piping (wing 28"; cradle 18") Price is per foot.			
63	H.80300	Draught rubber, van door bottom		1	NCA			Please measure and order # of feet required. 1			3.94'
81	H.62487	Tread bead, rubber (28") front cab		2	62.50						
	H.60649A	Piping (108") price per foot, BLUE		10'	9.50'						
		Please measure and order # of feet required.									

For upholstery or carpet sets, please inquire. Currently, we do not have a pattern available to manufacture these sets.

Manuals

No	Part #	Description	Application	Qty Req	Price Each
	PC-297	Minx 1936-9 Parts Catalog			60.45
	SM-300	Minx Phase I & Ten Estate Shop Manual			76.95
	PC-302	Ten Estate Car Phase I Supplement, Parts Manual			21.95
	HB-330	Minx Phase I Owner's Handbook			32.95
	PC-300	Minx Phase I Parts Manual			53.85
	HB-332	Minx Phase II Owner's Handbook			32.95
	PC-304	Minx Phase II Parts Manual			43.95

All manuals are reprinted from originals.



Hillman Minx Phase II Drophead Coupe



The Hillman Phase Minx Utility (Estate)

History:

The monocoque Minx Phase I was revealed in September 1939 and was sold in limited numbers to civilians during the early years of the war as a family sedan that was moderately priced. In November 1942, Rootes was confined to manufacturing military machinery suspending all civilian vehicle production. About 10,000 Phase I vehicles sold during this period. In the summer of 1945, Rootes was able to start up civilian deliveries once again of the popular saloon; however, very few could afford a new vehicle.

The Phase II was introduced in December 1947 when the front end was restyled to incorporate the headlamps into bulbous wings and fitted with a synchromatic steering-column gear shift. The cable brake system had been replaced by hydraulics during 1947.

By 1948, however, this type of Minx was beginning to look distinctly old-fashioned; it was replaced by the true postwar generation car, the Loewy-styled Minx III now referred to as the Series Minx.

Hillman Minx Phase I & II Specifications

Produced: Humber Road, 1939-42, Ryton-on-Dunsmore, 1945-48.

General layout: Unit-construction body-chassis structure in saloon, drophead coupe(DHC) and estate car bodies. Front mounted engine, driving rear wheels.

Engine and Transmission: Hillman engine, 4-cylinder, sv, in-line. 1,185 cc, 63x95mm, 35bhp at 4,100rpm; 4-speed gearbox, no synchromesh on 1st gear; centre-floor gear-change on Phase I, steering-column on Phase II; live (beam) rear axle with spiral-bevel final drive.

Chassis: Beam-axle front suspension, half-elliptic leaf springs.



Hillman Minx Phase II Saloon

Worm-and-nut steering. Live beam rear axle, half-elliptic leaf springs and anti-roll bar. Front and rear drum brakes. 5.00-16 in tyres.

Dimensions: 7'8" wheelbase; front track 3' 10.9"; rear track 4' 0.5"; length 12' 9.75" (Phase II 13'); width 5' 0.5"; height 5' 2.5". Unladen typical weight 1,905 lbs (Phase II 2,045 lb).

Performance: Maximum speed 65mph; 0-50 25.7 sec; 31 mpg.

Distinuishing features from precious models:

The first unit-construction Hillman, with similiar styling to previous Minx model; Phase II model had new full-width nose with faired-in headlamps, and steering column gear-change.

Derivatives: None

Fate: Phase I replaced by Phase II in December 1947, Phase II discontinued in 1948 in favor of the new Loewy-styled Phase III.

Kip Motor Company, Inc.
2127 Crown Road
Dallas, Texas 75229



One Click Does It All!

Secure, online shopping for all
parts in this catalog at
www.kipmotor.com